

SHOVEL RESEARCH

ROD STEWARD INSTALLATION GUIDE

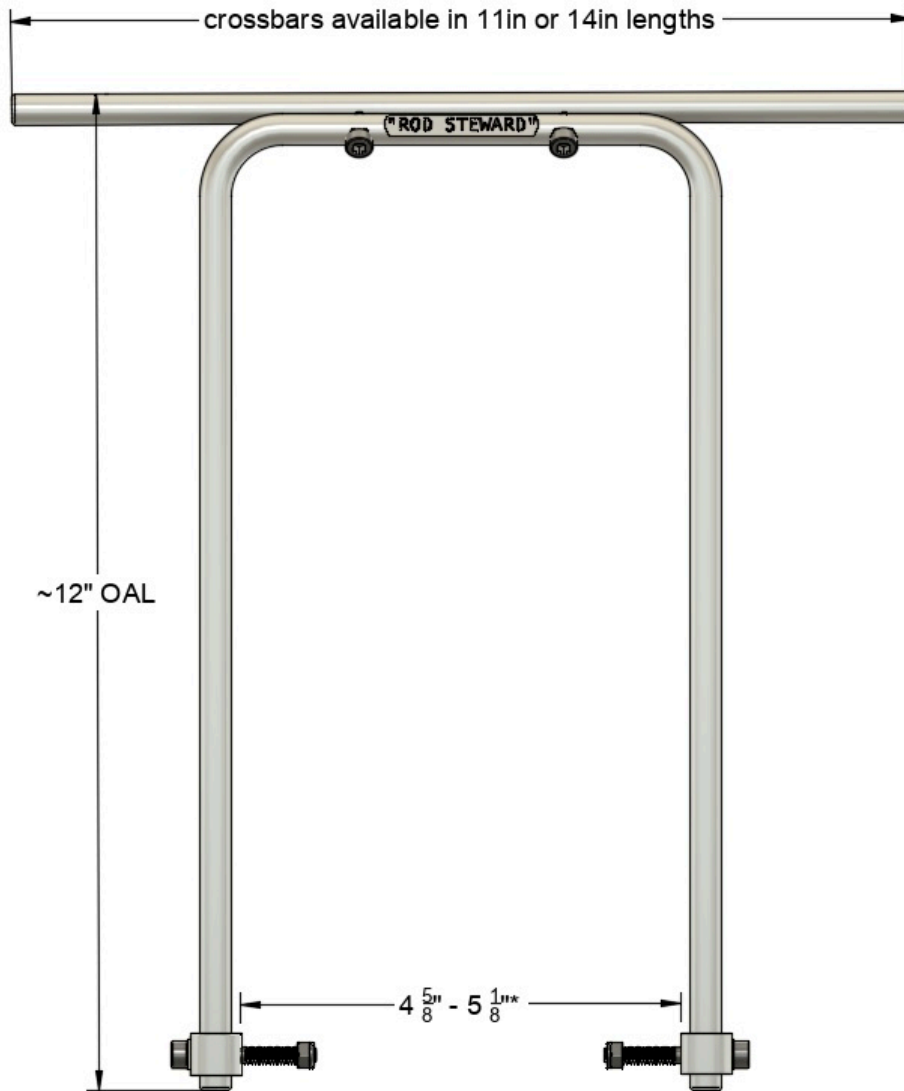

Tools needed: 4mm hex key, 8mm wrench
Tools probably needed: hacksaw & file, or other trimming method

Before continuing, make sure your bike has an outside-to-outside measurement of 4" to 5-1/8" between braze-ons. Custom bends are available to suit wider forks than that range. For anything less than 4-5/8", you'll need spacers, available separately:

4-4.25" - get a set of 8mm spacers
4.25"-4.5" - get a set of 5mm spacers
4.5-4.625" - get a set of 3mm spacers

If you're in between these recommendations go with the larger spacer.
It's not necessary to measure any more precisely than to the nearest 1/8in.

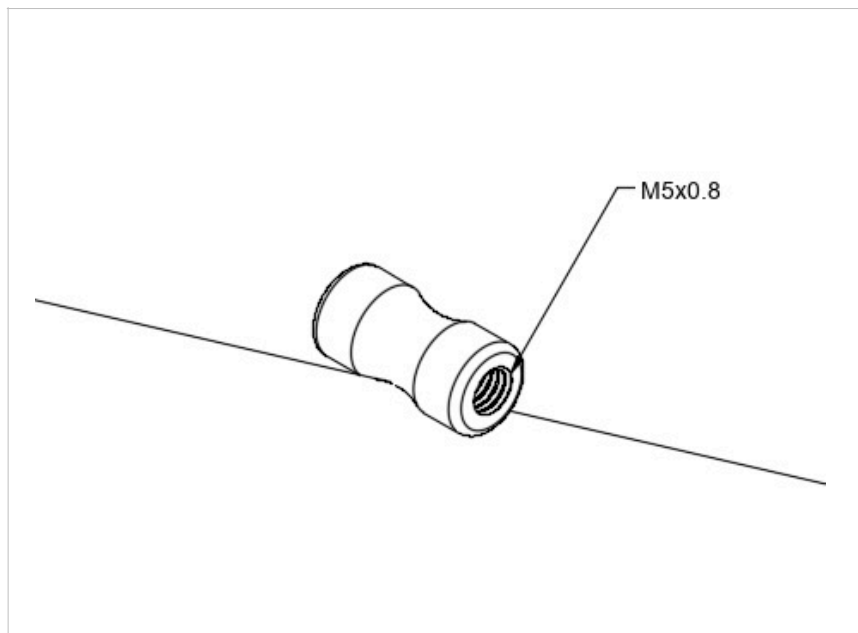

1

Thanks for your purchase!

Make sure the threads on your bike are clean and run a tap through them if needed. This guide assumes you have confirmed this product will work on your bike, and that your bike is metal with appropriate braze ons.

Installation on carbon bikes/forks is not recommended. Consult manufacturer before proceeding.

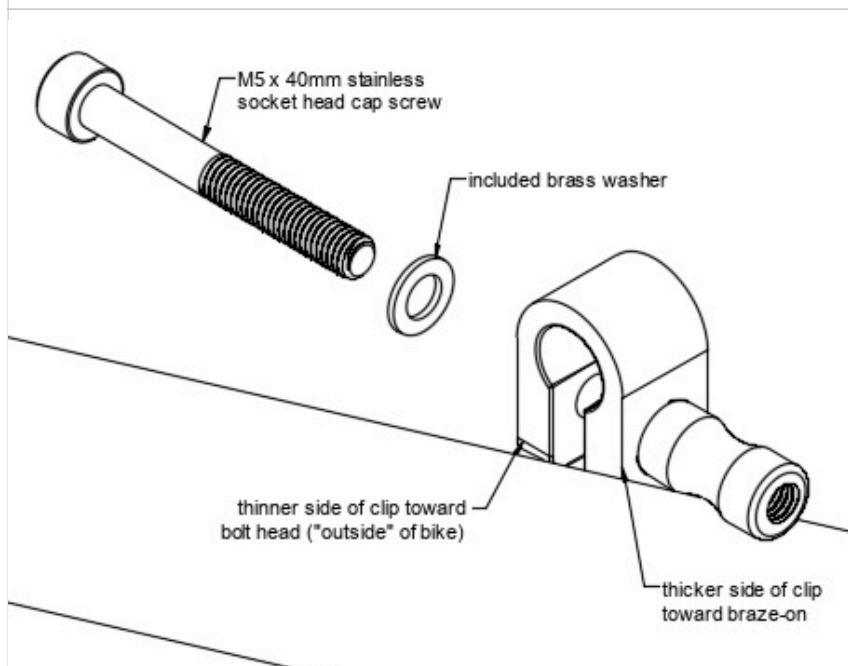

2

Determine the orientation of each clip (see illustration) and install them onto your bike with the 40mm bolts + washers, leaving them quite loose at this stage.

Insert the ends of the bent U-shaped rod through both clips at the same time if you can (it's usually easier to do this with both hands, approaching from the front of the bike)

Now you may tighten the bolts, but don't snug them all the way until your bag is adjusted in position.

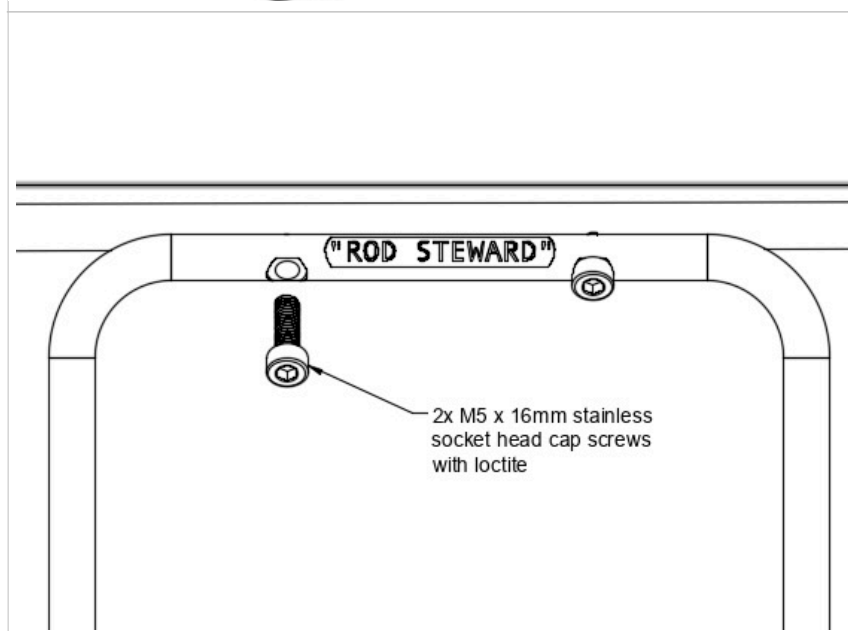

3

If the crossbar is not already bolted onto the bent U-shaped rod, you may do so now using the M5 x 16mm bolts with pre-applied loctite.

Leaving them slightly loose will allow you to gently wrestle the webbing on the bottom of your Fab's chest onto the crossbar to check fit. You may wish to also hang your bag from the handlebars or saddle loops to make checking fit easier.

4

With the bag in place, evaluate the installation at this point. The support should be well-positioned to support your bag from underneath and at a good angle, about 30-45° from the steering axis. That's the aesthetic green zone shown in this diagram. Give your eyeball protractors some practice here — that's half of building bikes anyway.

If the installation is looking good but the legs are too long, mark them carefully about 1/4" away from the clip, and uninstall to trim. Measure multiple times and cut once(!) — making sure you leave at least 0.20" of rod sticking out past the clip.

After cutting, file away any sharp edges or burrs.

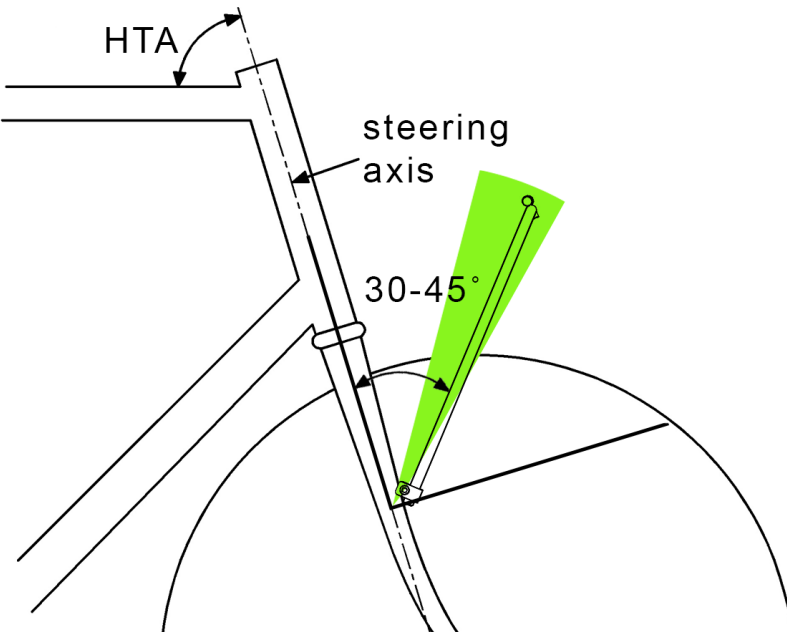

5

Secure your bag, finalize your adjustments and tighten all 4 bolts completely.

Lastly, install the nylok nuts provided on the other side of your bike's braze-ons. These are necessary, and preferable to other forms of thread locking.

Please note that the Rod Steward should not be installed without thread lockers.

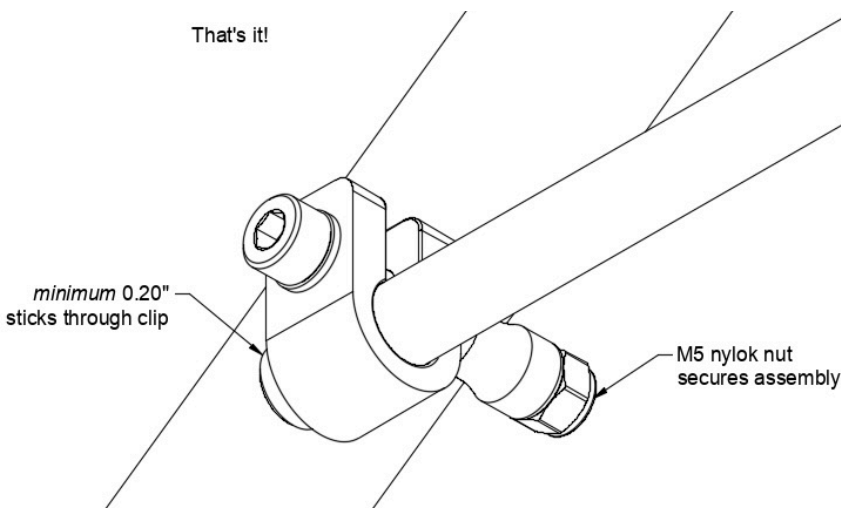

NOTES

Not to be used without a bag. Never ride your bike with the Rod Steward installed and no bag.

Not a rack replacement. Designed to triangulate the hanging weight of the bag against your fork or frame in order to stabilize it, not to lift its full weight. Your bag should have enough room to hang from the handlebars or saddle loops in order to be compatible with this product.

As with any accessory, all connections should be checked and tightened regularly before riding. Improper installation may lead to failure.

While everyone should be encouraged to work on their own bicycles, please ask a qualified mechanic for help if any part of this is new to you.

For any product related questions or comments please write to sal@shovelresearch.com