



RUFF

Liam Seear-Budd

March 15th - April 1st

'Ruff' is an immersive art exhibition that unveils the captivating synergy between human creativity and artificial intelligence. Through a series of vibrant dog portraits, the collection challenges traditional notions of artistic authorship. It evokes the elusive nature of an AI dog park, where emotions persist while details resist focus—a reflection of the emotional bonds shared with our four-legged friends.

Liam Seear-Budd's work transcends conventional boundaries, creating a contemplative space that not only celebrates the emotional richness of these connections but also prompts reflections on the evolving role of technology in artistic expression—a testament to the ever-expanding canvas of 21st-century creativity.



1. **'Ruff'**
-Synthetic Polymer on Italian Cotton
-56 X 71cm
-\$600
2. **'Sit!'**
-Synthetic Polymer on Italian Cotton
-127 X 81cm
-\$1000
3. **'Best In Show'**
-Synthetic Polymer on Italian Cotton
-56 X 71cm
-\$600
-
4. **'Bad 2'**
-Synthetic Polymer on Italian Cotton
-35 X 56cm
-\$250
5. **'Good Boys'**
-Synthetic Polymer on Italian Cotton-127 X 81cm
-\$1000
6. **'The Bone'**
-Synthetic Polymer on Italian Cotton
-35 X 56cm
-\$250
-
7. **'Hit A Lick'**
-Synthetic Polymer on Italian Cotton
-71 X 86cm
-\$700
8. **'Sploot'**
-Synthetic Polymer on Italian Cotton
-58 X 81cm
-\$660
9. **'Dooby Doo'**
-Earthenware & Glaze
-\$600
10. **'Puppy Dog Eyes'**
-Earthenware & Glaze
-\$750
11. **'Plop'**
-Earthenware & Glaze
-\$600
- 'RUFF' T Shirts**
-\$65

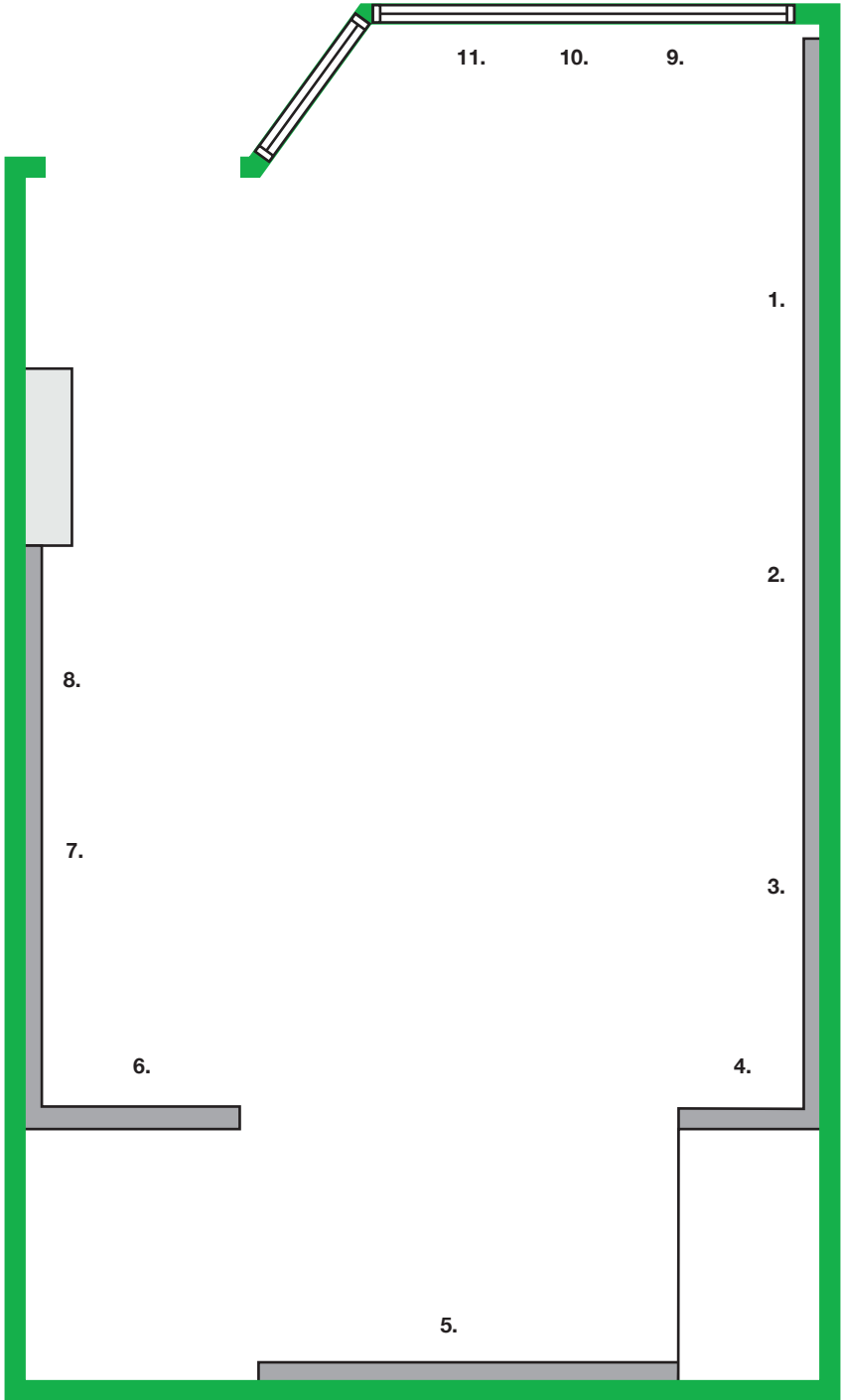

Liam Seear-Budd is an Aotearoa-born, Naarm-based artist working over painting, photography, and graphic design mediums. Best known for his layered approach to glass painting, Liam's experimental practice stands as an evolution of nostalgia and past experiences.

Harnessing feelings and emotions as the driving force of the creative process, all artworks have undergone an extensive process of revision as it was moulded and coaxed into it's fully realised form, a process that Liam describes as being akin to therapy for him.

Green Floor Gallery recognise that we operate our business on the land of the Kulin Nations. We acknowledge the Wurundjeri people who are the Traditional Custodians of the land on which we work and live. We pay our deep respects to their Elders, past and present.

Sovereignty was never ceded. It was, and always will be Aboriginal land.



*Exhibitions at **Green Floor Gallery** are thoughtfully curated to showcase a diversity of artistic styles, mediums, and perspectives.*

Green Floor Gallery is committed to promoting emerging talent and underrepresented voices. Through special exhibitions, collaborations, and initiatives, we aim to shine a spotlight on artists whose work challenges conventions and enriches our collective cultural landscape.

*info@greenfloor.gallery
@greenfloorgallery*

EXHIBITION is sponsored by 3 RAVENS & KONPIRA MARU.