

Portfolio, Nicholas Gleeson.
Graphic Designer and founder of design practice 0-ln.

I produce design works that aim to combine contemporary aesthetics with a research led methodology, creating meaningful design expressions that cater to the needs of modern practice.

Contact information
e: n@0-ln.co
@: [moma1000000](https://www.instagram.com/moma1000000), [0_ln_](https://www.instagram.com/0_ln_)
www: nicholasgleeson.com, 0-ln.co
p: (+04) – 68 – 381 – 320

Education
Bachelor of Communications Design (Design), RMIT
Associates Degree (Fashion and Textile Merchandising), RMIT
Bachelor of Communications (Journalism), Swinburne

Projects in this folio span:

In the form of:

for clients including:

Architecture
Fashion
Graphic Design
Fine Art
Photography
Academia

Publication
Website
Exhibition
Portfolio
Campaign
Printed Matter

Tread Journal
MPavillion
Ernie Van Amstel
RMIT
Marcel Schlooz (*Lyons*)
Amina Basam

<u>Select Works</u>	<u>Client</u>	<u>Disciplines</u>	<u>Outputs</u>	<u>Collaborators</u>	<u>Associated</u>	<u>Year</u>
01. Tread Journal	Amina Basam, Ava Simpson, Isaac Wise	Architecture	Publication, Identity	Timon Meury, Zachariah Micallef	ARM Architecture RMIT School of Architecture	2024 → Ongoing
02. Digital Portfolio	Ernie van Amstel	Editorial, Photography, Fine Art	Website	Timon Meury, Zach Moore		2024
03. Press, Hold, Fold: <i>What's inside the suitcase?</i>	Leanne Choi, MPavillion,	Fashion Design	Publication	Timon Meury, Finn Stewart	RMIT Masters of Fashion Design, Ziga Testen	2024
04. Mine: <i>Major Project</i>	Marcel Shlooz (<i>Lyons</i>)	Architecture	Poster		RMIT School of Architecture	2023
05. Print Portfolio	Amina Basam	Architecture	Portfolio		RMIT School of Architecture	2024
06. PRESS: <i>RMIT UGCD Graduate Showcase</i>	RMIT Communications Design Faculty	Various	Project Management, Publication, Website, Spatial Design, Identity, Social Media Strategy	Timon Meury, Finn Stewart, Zachariah Micallef, Liam Kenna, Ella Taylor	Brad Haylock, Counter-Forms, Ziga Testen, Wei Huang, Suzie Zezula, Jiayu Chen (<i>Sandwich Press</i>)	2023

Tread Journal

Commissioned by Amina Basam, Ava Simpson & Isaac Wise. Tread is an independent architecture and design publication, aimed at platforming young and early career practitioners.

Project Details:
Paperback, 120pp.
148 x 210mm + Insert

Typefaces:
Rag, Wremena

Collaborators
Timon Meury,
Zachariah Micallef

Associated
ARM Architecture,
RMIT School of
Architecture

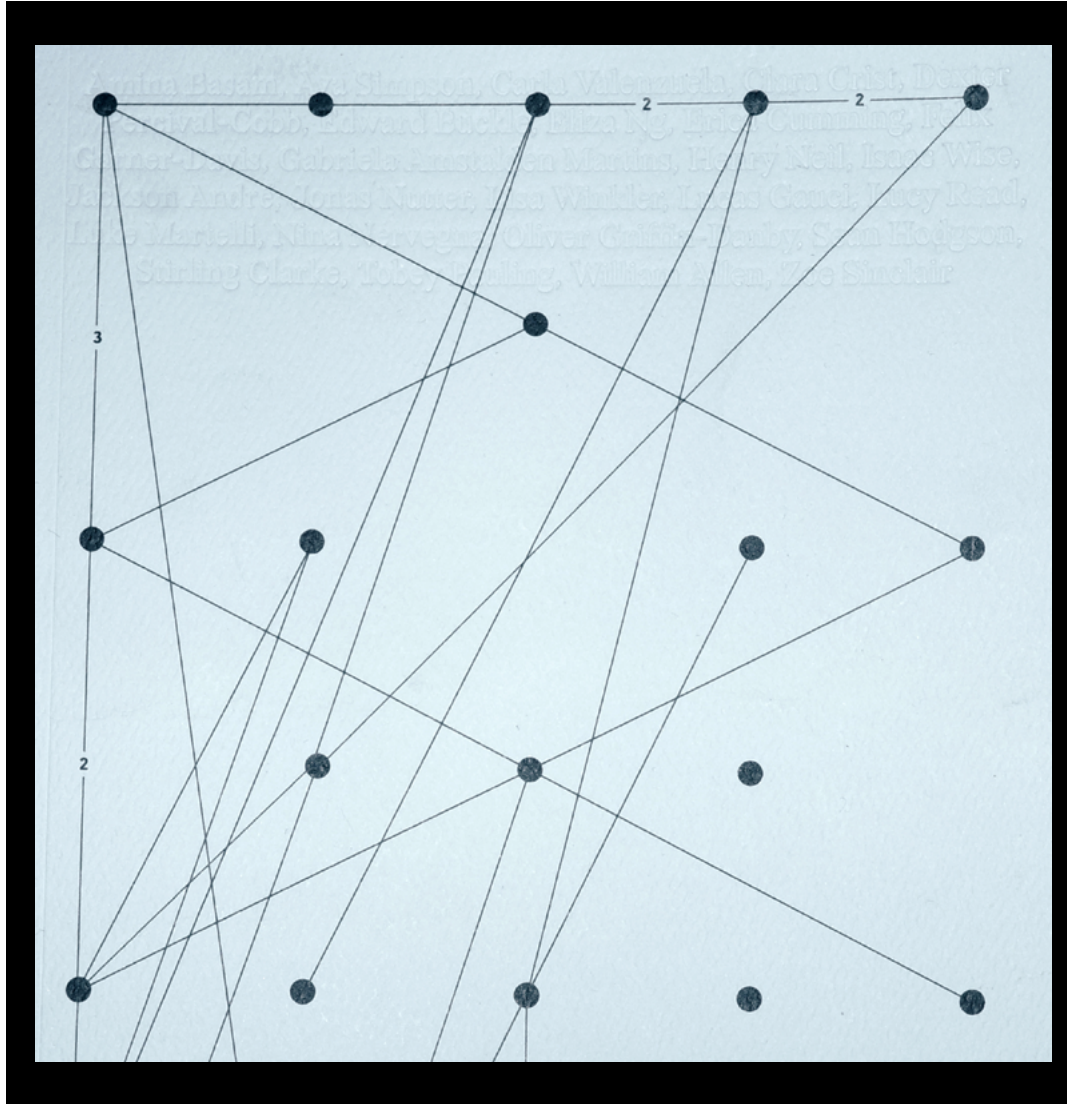

01. Cover System and contributor name deboss. The dot & line system adapts to the initials of the contributors.

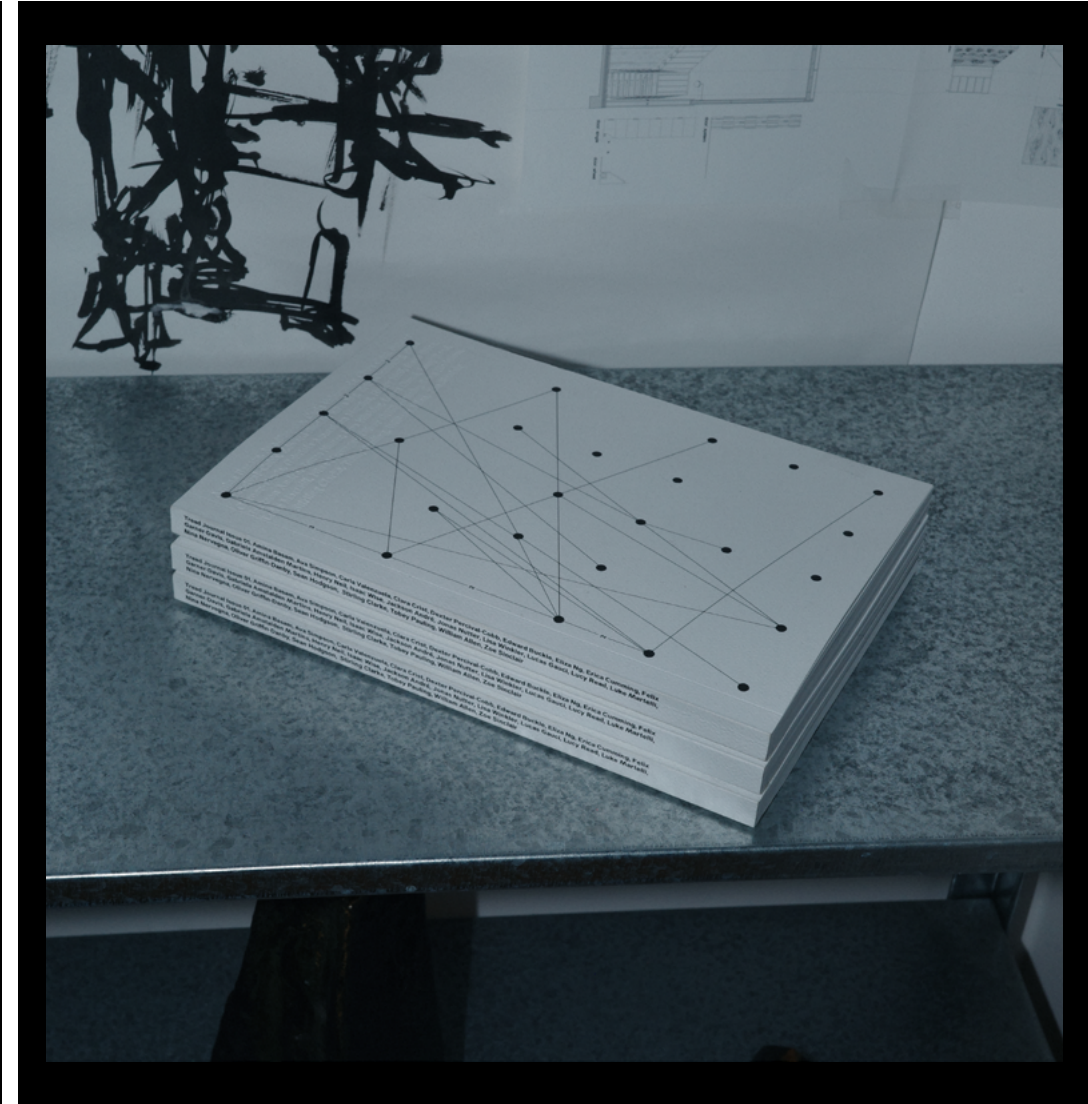

02. In-Situ photography of the publication. Spine features contributor names in plain text.

Commissioned by Amina Basam, Ava Simpson & Isaac Wise. Tread is an independent architecture and design publication, aimed at platforming young and early career practitioners.

Project Details:
Paperback, 120pp.
148 x 210mm + Insert

Typefaces:
Rag, Wremena

Collaborators
Timon Meury,
Zachariah Micallef

Associated
ARM Architecture,
RMIT School of
Architecture

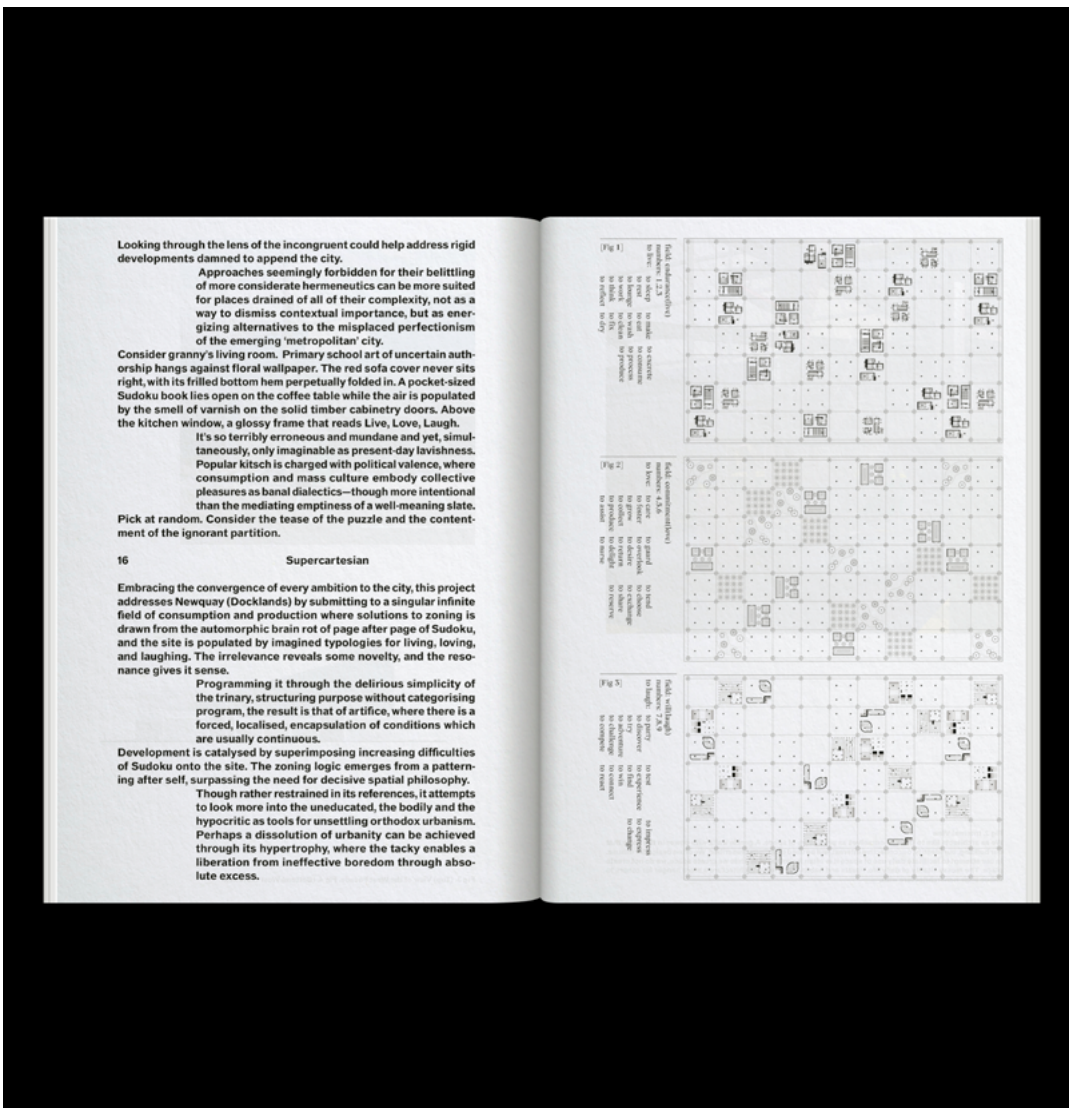

03. A view of the publication highlighting the line based footnote system, intended to utilise the visual imprint of architectural drafting.

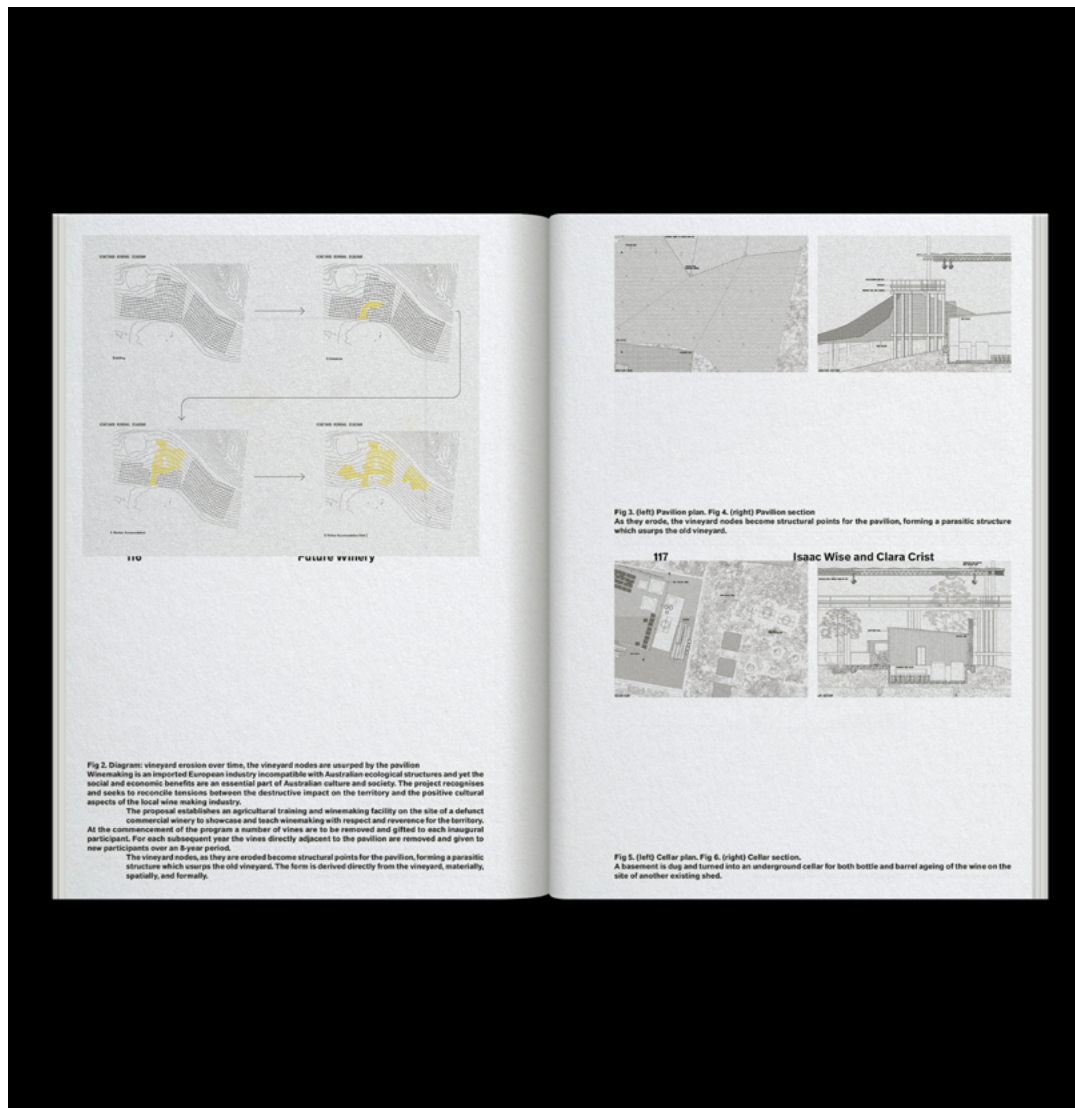

04. The content types presented spanned diverse categories, but as the primary submissions were architecturally related, there often required multiple methods of notation. Featured are a few footnote styles.

Tread Journal

Commissioned by Amina Basam, Ava Simpson & Isaac Wise. Tread is an independent architecture and design publication, aimed at platforming young and early career practitioners.

Project Details:
Paperback, 120pp.
148 x 210mm + Insert

Typefaces:
Rag, Wremena

Collaborators
Timon Meury,
Zachariah Micallef

Associated
ARM Architecture,
RMIT School of
Architecture

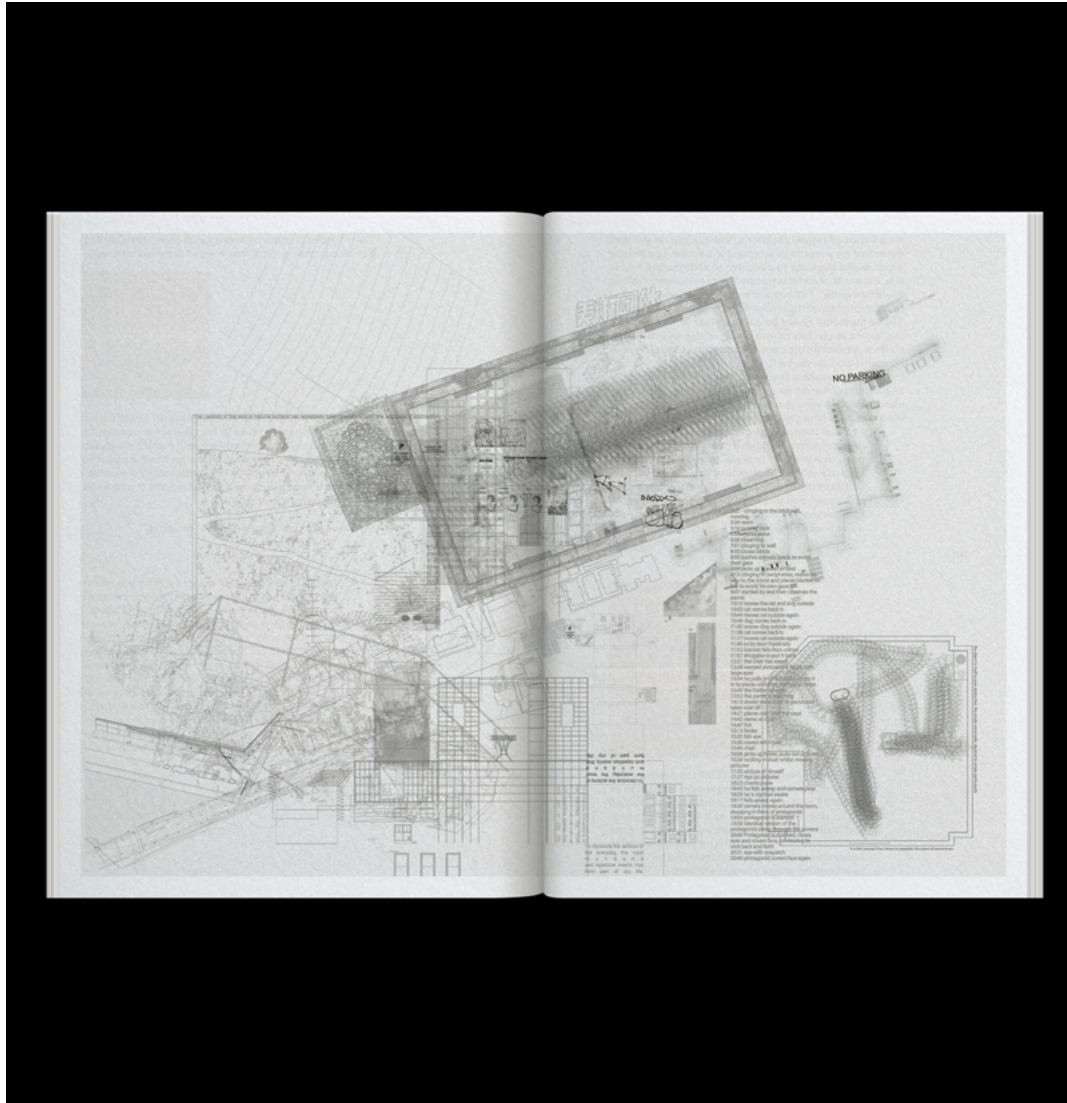

05. A double spread of a submission. Each line drawing segment was backed with a gray rectangle to give the delicate work a grounding feature on the page.

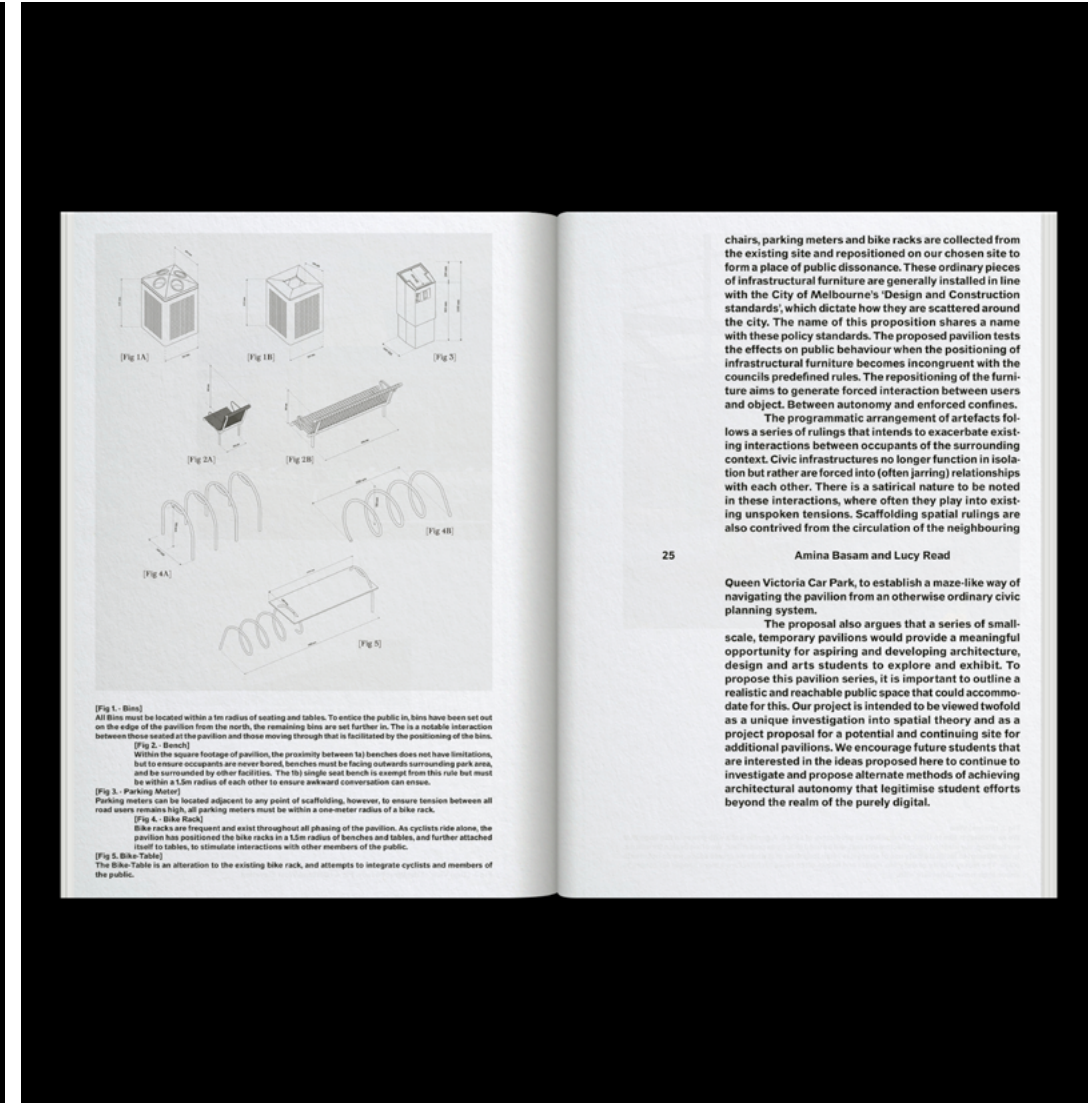

06. One of the type styles used for large body copy alongside a combination of footnotes and in-image citation.

Tread Journal

Commissioned by Amina Basam, Ava Simpson & Isaac Wise. Tread is an independent architecture and design publication, aimed at platforming young and early career practitioners.

Project Details:
Paperback, 120pp.
148 x 210mm + Insert

Typefaces:
Rag, Wremena

Collaborators
Timon Meury,
Zachariah Micallef

Associated
ARM Architecture,
RMIT School of
Architecture

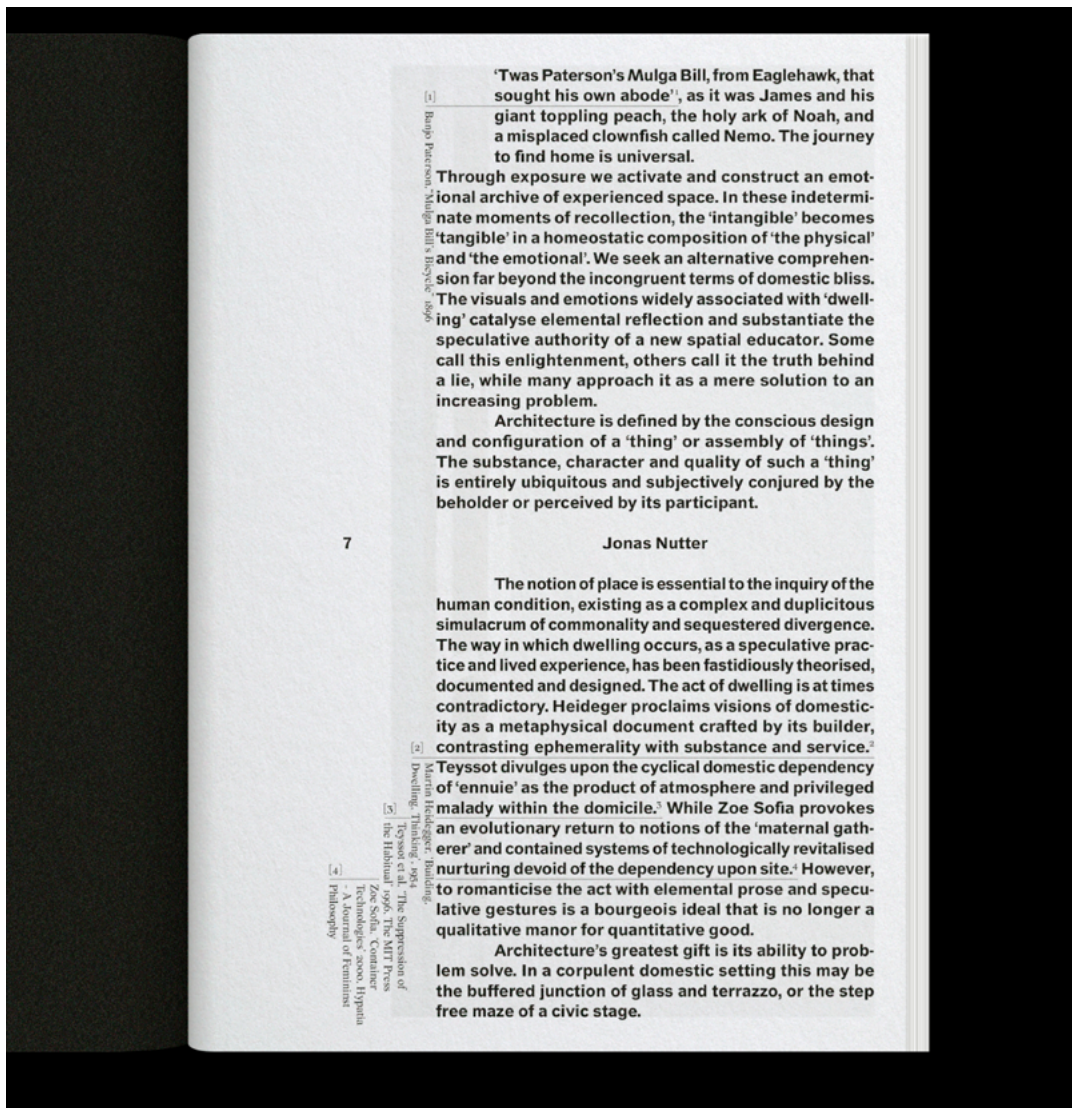

07. A full text spread that features the back side of the chapter break, as well as the line-based citation sitting within text. The lines are relative to the position of the reference within the text, nested towards the spine.

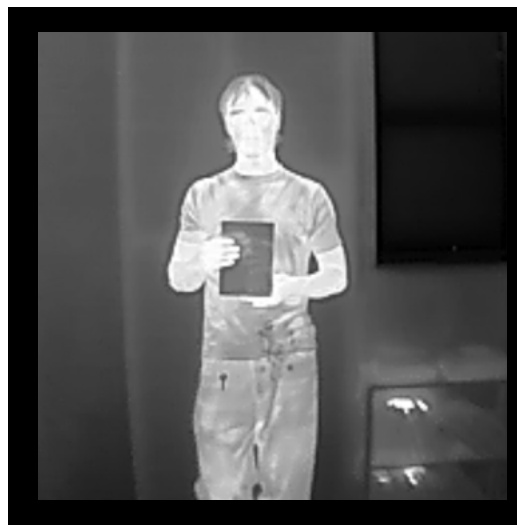

08.



09.



10.



11.

08. 11. Thermal Camera Documentation.
09. Photographic documentation of full spread.
10. In-Line graphic on foldout poster.

Digital Portfolio

This project was commissioned by Ernie van Amstel, an interdisciplinary practitioner. This site functions as a repository of previous works, while also acting as a platform for her current and future output.

It can be accessed at amstelvan.com

Project Details:
Website
(Desktop & Mobile)

Typefaces:
Söhne Kräftig

Collaborators
Timon Meury (Design)
Zach Moore (Dev)

Associated
Featured on Klikkentheke
(#1001)

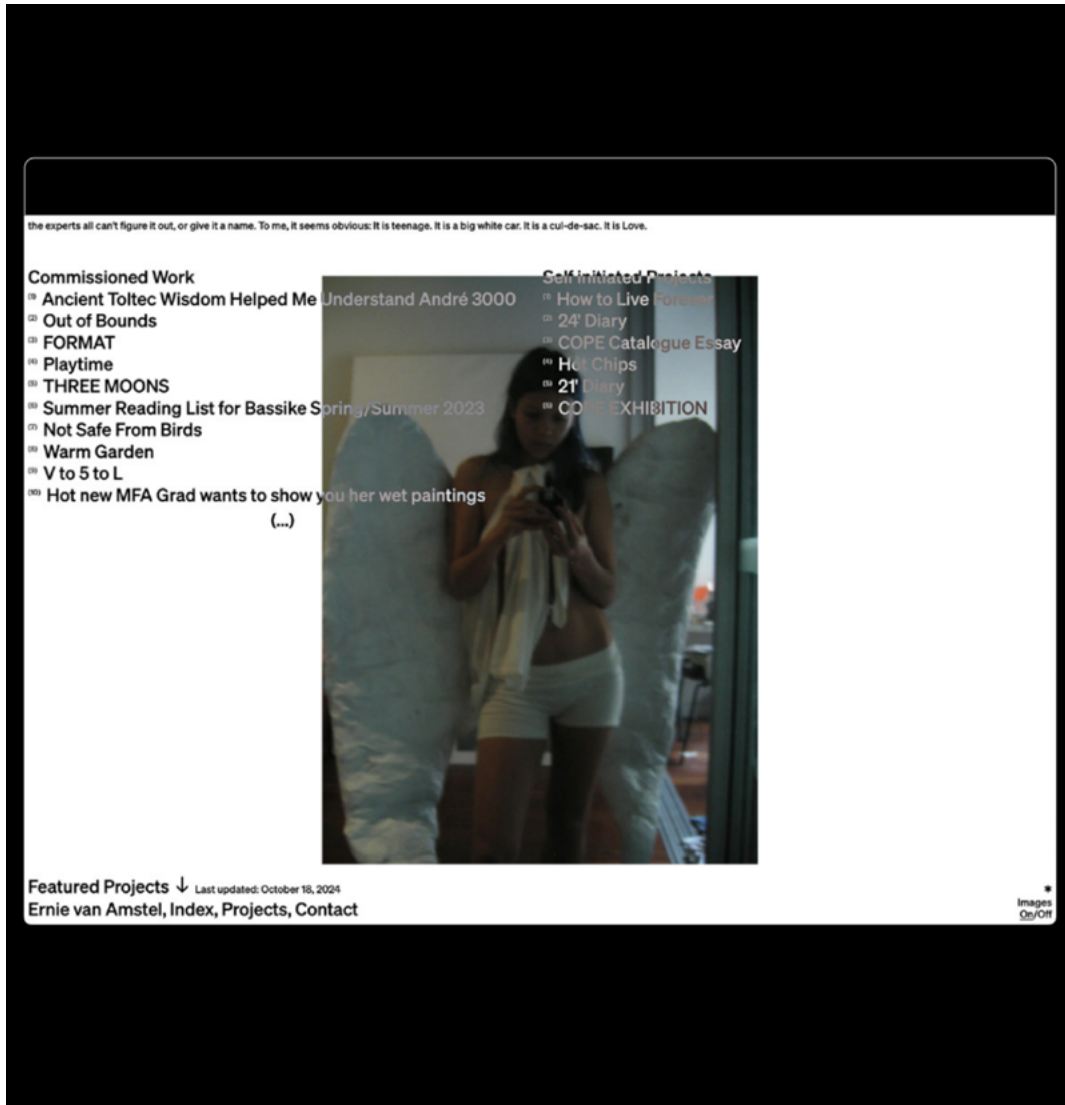

01. Landing page with directory. Segmented into self initiated work and client work, as well as a long scroll of 'staged' content when scrolled down (not shown).



02. Our own documentation photography of the mobile view.

Digital Portfolio

This project was commissioned by Ernie van Amstel, an interdisciplinary practitioner. This site functions as a repository of previous works, while also acting as a platform for her current and future output.

Project Details:
Website
(Desktop & Mobile)

Typefaces:
Söhne Kräftig

Collaborators
Timon Meury (Design)
Zach Moore (Dev)

Associated
Featured on Klikkentheke
(#1001)

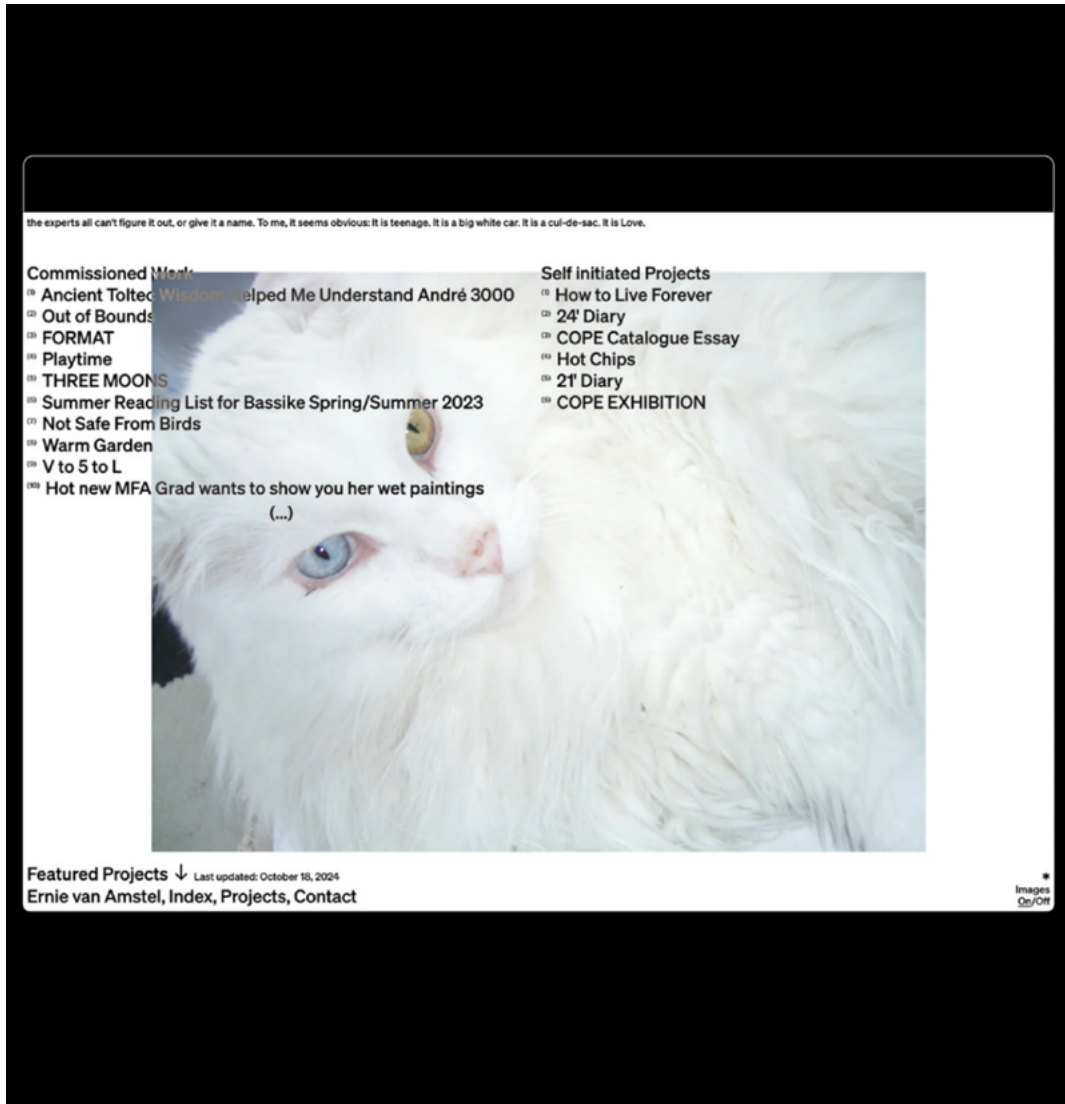

03. Alternate view of the landing directory.



04. The in-article view showcasing colophon information, text and image staging.

Digital Portfolio

This project was commissioned by Ernie van Amstel, an interdisciplinary practitioner. This site functions as a repository of previous works, while also acting as a platform for her current and future output.

Project Details:
Website
(Desktop & Mobile)

Typefaces:
Söhne Kräftig

Collaborators
Timon Meury (Design)
Zach Moore (Dev)

Associated
Featured on Klikkentheke
(#1001)

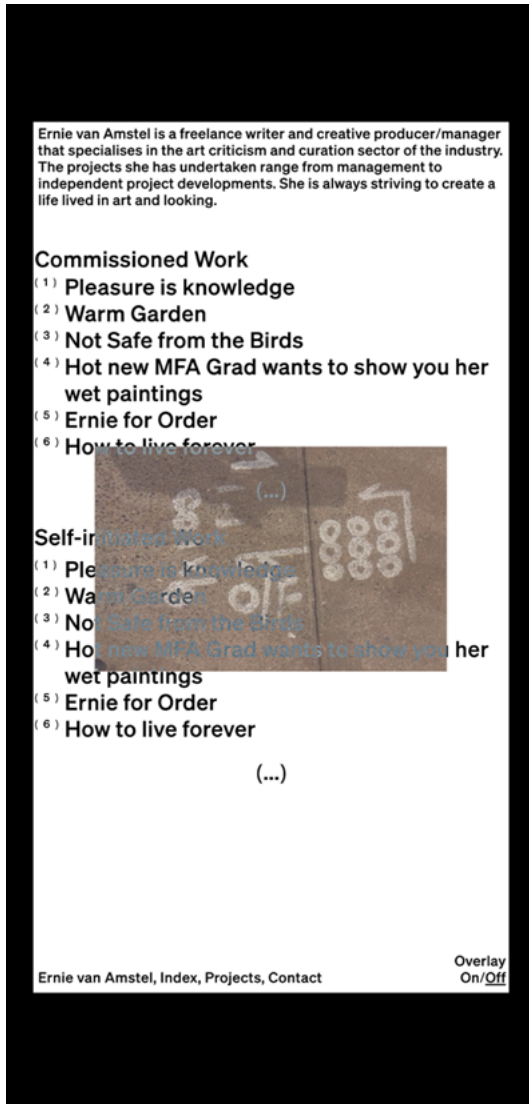

05.
Mobile landing page.

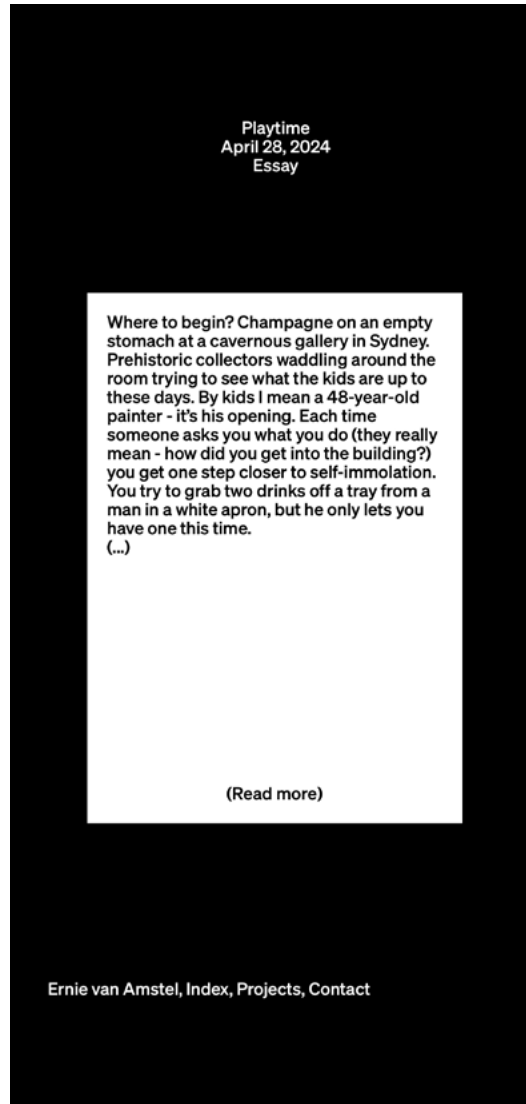

06.
Mobile Feature view.

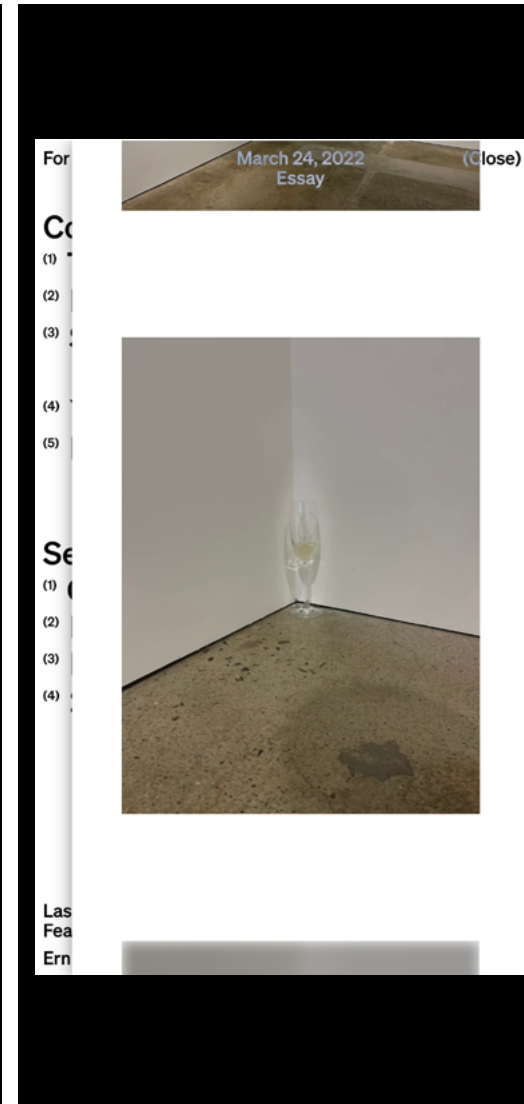

07.
Mobile image view.

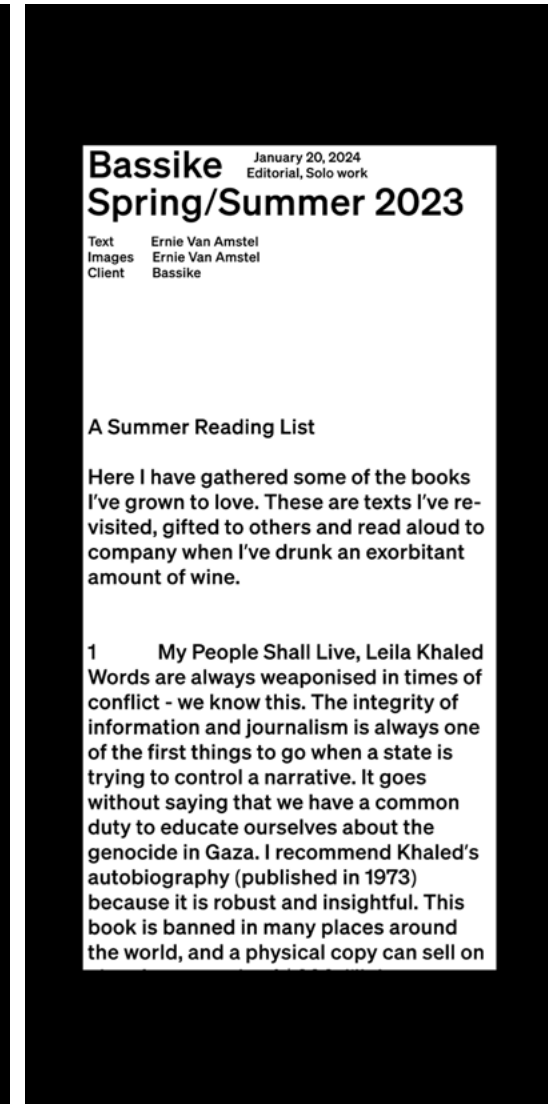

08.
Mobile text article.

Digital Portfolio

This project was commissioned by Ernie van Amstel, an interdisciplinary practitioner. This site functions as a repository of previous works, while also acting as a platform for her current and future output.

Project Details:
Website
(Desktop & Mobile)

Typefaces:
Söhne Kräftig

Collaborators
Timon Meury (Design)
Zach Moore (Dev)

Associated
Featured on Klikkentheke
(#1001)



09. Our own photographic documentation of the desktop index.



10. Top A view of the in-article image view, showing the flyover UX (seen on left)

11. Bottom A view of desktop projects page. This is a visual alternative to the index.

Press, Hold, Fold: What's inside the suitcase?

This project was commissioned by fashion designer Leanne Choi and MPavillion. The publication is a part look-book, part accessory that was created to be used as a supplementary 'look' within the collection. The project explored the designer's relationship to diaspora and placelessness.

Project Details:
Unbound, 148pp.
210 x 197mm
+ inserts

Typefaces:
Monument Grotesk,
EK Roumald

Collaborators
Timon Meury,
Finn Stewart

Associated
Ziga Testen,
RMIT Masters of
Fashion Design



01. The publication was broken down into sections based on each look. A core motif of the project was the notion of unfolding, as the dresses were object/garment hybrid works, transforming from suitcase to worn garment.

02. Select spreads featuring different closeups. The design was intended to be unintrusive, allowing for the garments to take central focus.

Press, Hold, Fold: *What's inside the suitcase?*

This project was commissioned by fashion designer Leanne Choi and MPavillion. The publication is a part look-book, part accessory that was created to be used as a supplementary 'look' within the collection. The project explored the designer's relationship to diaspora and placelessness.

Project Details:
Unbound, 148pp.
210 x 197mm
+ inserts

Typefaces:
Monument Grotesk,
EK Roumald

Collaborators
Timon Meury,
Finn Stewart

Associated
Ziga Testen,
RMIT Masters of
Fashion Design



03. Materials used in the garments were custom made using scanographic capture of reclaimed materials (Grandma's lace, childhood ephemera, etc.), digitally manipulated, and then reprinted.

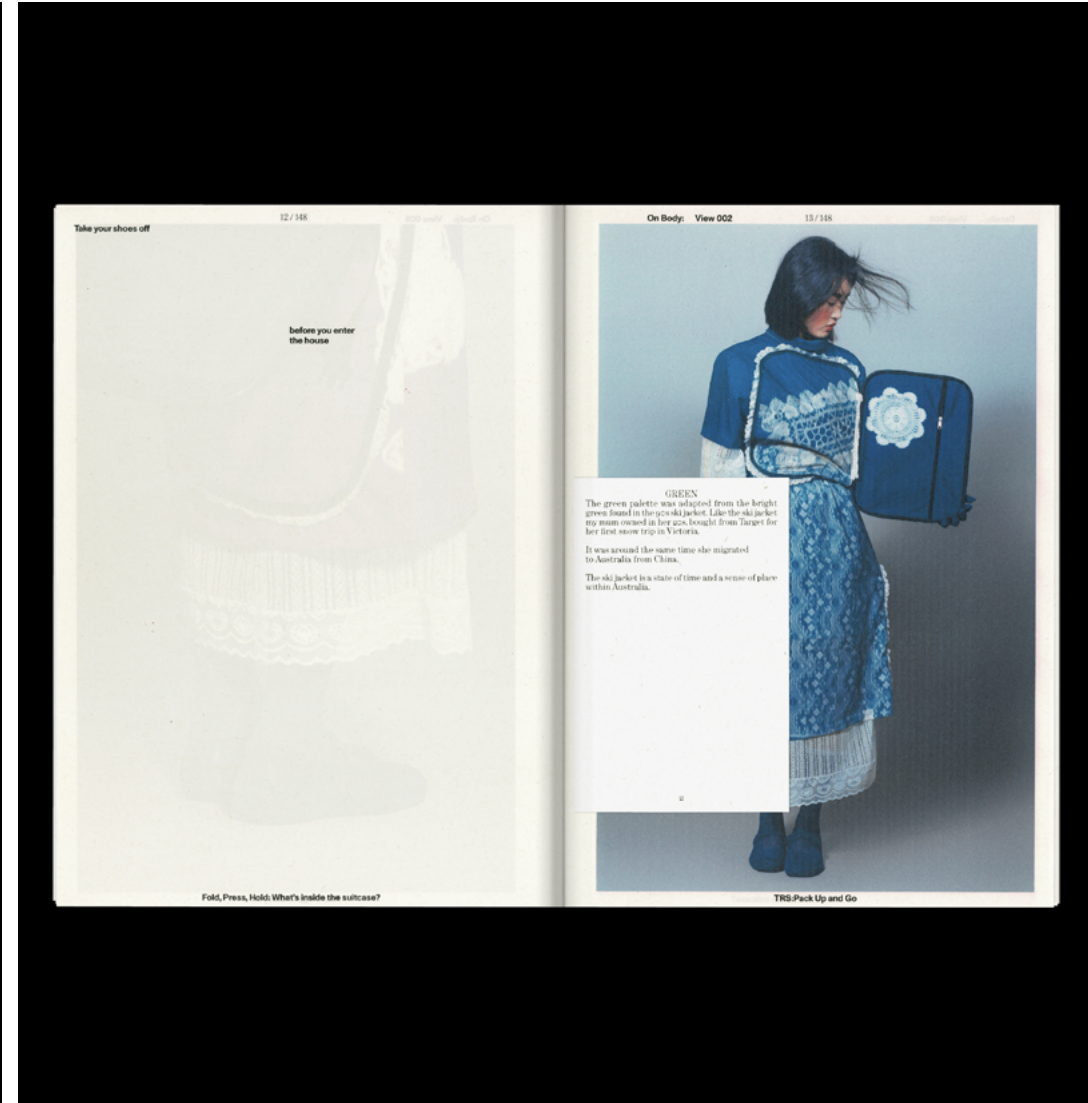

04. Within the publication, small narrative fragments were provided as floating inserts to provide context to the looks. The entirety of the publication was created as unbound sections, to tap into the feeling of packing loose belongings into a suitcase.

Press, Hold, Fold: What's inside the suitcase?

This project was commissioned by fashion designer Leanne Choi and MPavillion. The publication is a part look-book, part accessory that was created to be used as a supplementary 'look' within the collection. The project explored the designer's relationship to diaspora and placelessness.

Project Details:
Unbound, 148pp.
210 x 197mm
+ inserts

Typefaces:
Monument Grotesk,
EK Roumald

Collaborators
Timon Meury,
Finn Stewart

Associated
Ziga Testen,
RMIT Masters of
Fashion Design



05. Micro and macro views of the garment object, emphasizing its transformative intentions.



06. The design philosophy opted for a consistent and measured presentation, so as not to detract from the imagery being presented.

Press, Hold, Fold: *What's inside the suitcase?*

This project was commissioned by fashion designer Leanne Choi and MPavillion. The publication is a part look-book, part accessory that was created to be used as a supplementary 'look' within the collection. The project explored the designer's relationship to diaspora and placelessness.

Project Details:
Unbound, 148pp.
210 x 197mm
+ inserts

Typefaces:
Monument Grotesk,
EK Roumald

Collaborators
Timon Meury,
Finn Stewart

Associated
Ziga Testen,
RMIT Masters of
Fashion Design



07. Included within the collection were custom made accessories to be worn by the models in the runway context. Each were created using similar scanographic techniques.



08. Writing within the publication itself consisted of small vignettes relating to Choi's lived experiences with the dress materials. These were intended to be small and vague, so as to feel like a clouded memory.

Press, Hold, Fold: What's inside the suitcase?

This project was commissioned by fashion designer Leanne Choi and MPavillion. The publication is a part look-book, part accessory that was created to be used as a supplementary 'look' within the collection. The project explored the designer's relationship to diaspora and placelessness.

Project Details:
Unbound, 148pp.
210 x 197mm
+ inserts

Typefaces:
Monument Grotesk,
EK Roumald

Collaborators
Timon Meury,
Finn Stewart

Associated
Ziga Testen,
RMIT Masters of
Fashion Design



09. To signify a chapter break, we employed a persistently spaced grid system that 'clicked' with the previous chapter's looks. This also served as a gallery view of all the looks combined as they unfolded, further emphasising the unfolding notion.



10. Social media documentation slices.

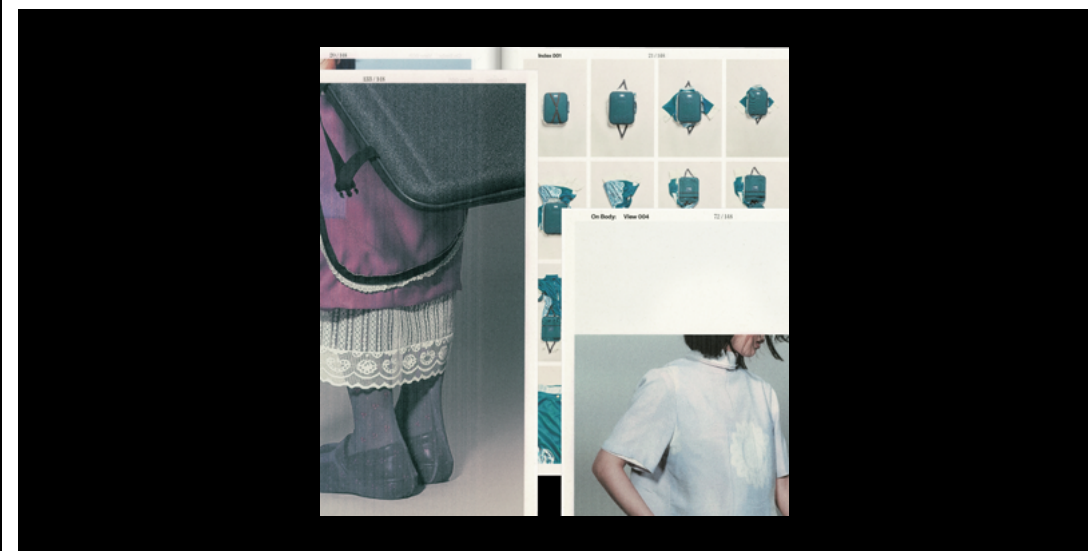

MINE

Commissioned by Marcel Shlooz (*Lyons*) for his RMIT Architecture Masters Major Project. This poster is a document illustrating post-capitalist building redundancies in Canberra (CNB) and Melbourne (MLB). Each component is scale accurate to the diagram requirements and all communicate information within the project.

Project Details:
Large Format Poster,
1.8m x 2.5m

Typefaces:
Lablii Grotesk, Tiny 5 x 3

Collaborators
Marcel Shlooz

Associated
RMIT School of
Architecture

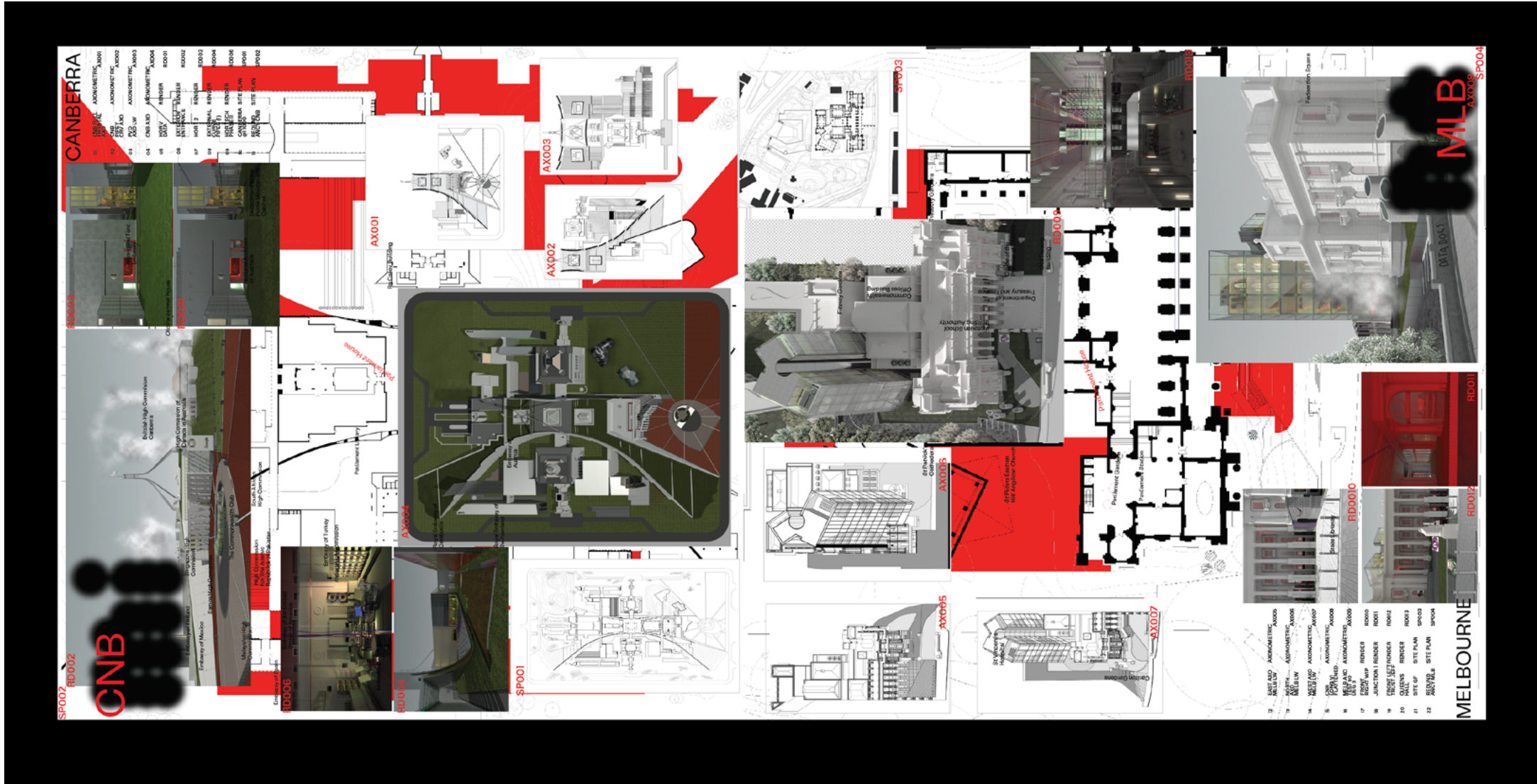

01. The entirety of the poster. It follows an vertically inverse composition, using the horizontal center as a divider between Canberra and Melbourne. The composition functions as several overlaid, geographically accurate maps placed without context. These were layered using transparencies (not shown).

MINE

Comissioned by Marcel Shlooz (*Lyons*) for his RMIT Architecture Masters Major Project. This poster is a document illustrating post-capitalist building redundancies in Canberra (CNB) and Melbourne (MLB). Each component is scale accurate to the diagram requirements and all communicate information within the project.

Project Details:
Large Format Poster,
1.8m x 2.5m

Typefaces:
Labil Grotesk, Tiny 5 x 3

Collaborators
Marcel Shlooz

Associated
RMIT School of
Architecture

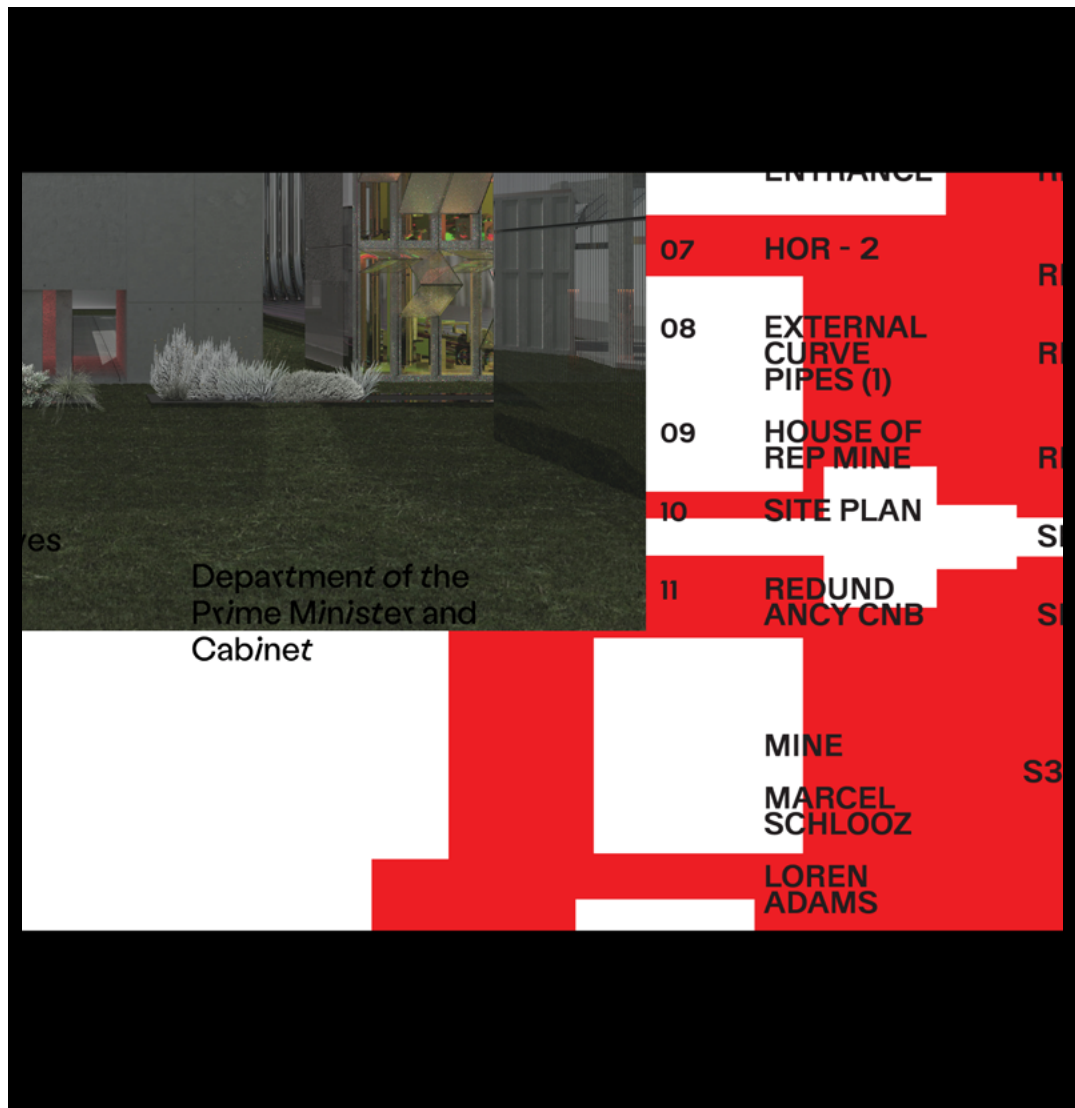
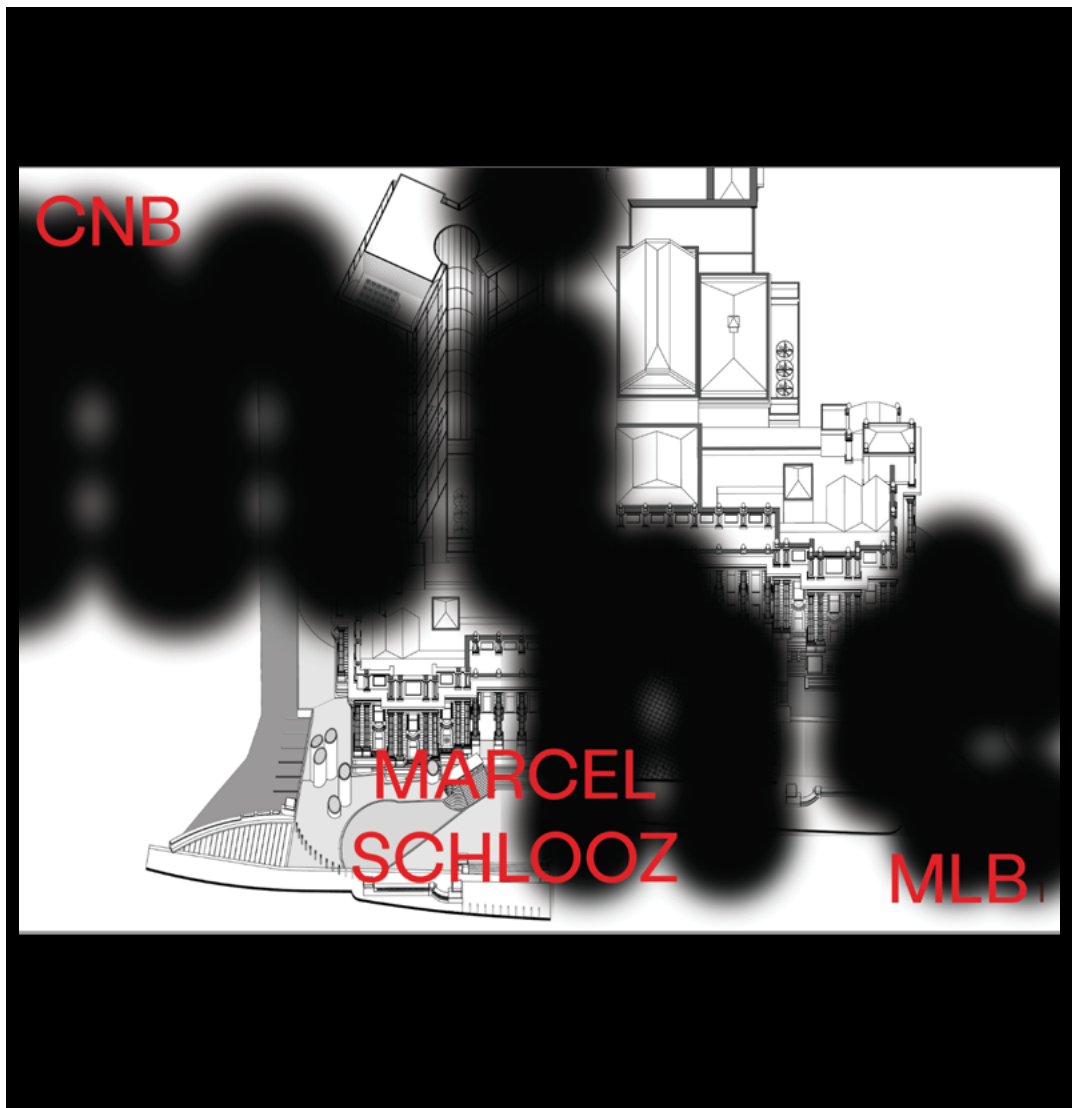

02. The cover of the presentation document, using a modified version of Tiny 5x3, maintaining the split motif.

03. A closeup of the pervasive index found on the poster. As it was large format, the purpose of this index was for viewers to be able to identify what they were looking at without needing supplementary material.

MINE

Comissioned by Marcel Shlooz (*Lyons*) for his RMIT Architecture Masters Major Project. This poster is a document illustrating post-capitalist building redundancies in Canberra (CNB) and Melbourne (MLB). Each component is scale accurate to the diagram requirements and all communicate information within the project.

Project Details:
Large Format Poster,
1.8m x 2.5m

Typefaces:
Labil Grotesk, Tiny 5 x 3

Collaborators
Marcel Shlooz

Associated
RMIT School of
Architecture

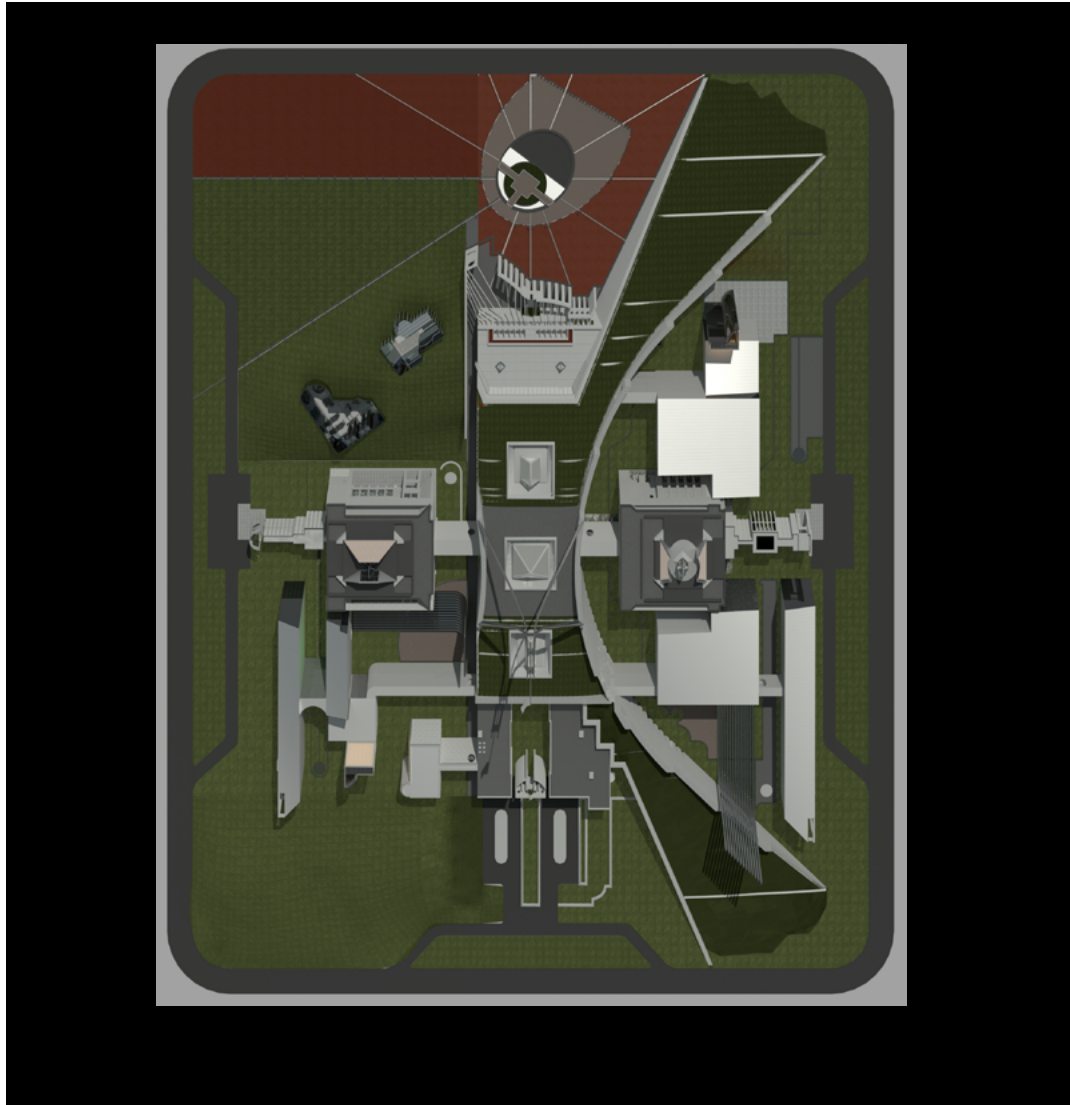

04-a. This image shows the rendered content.

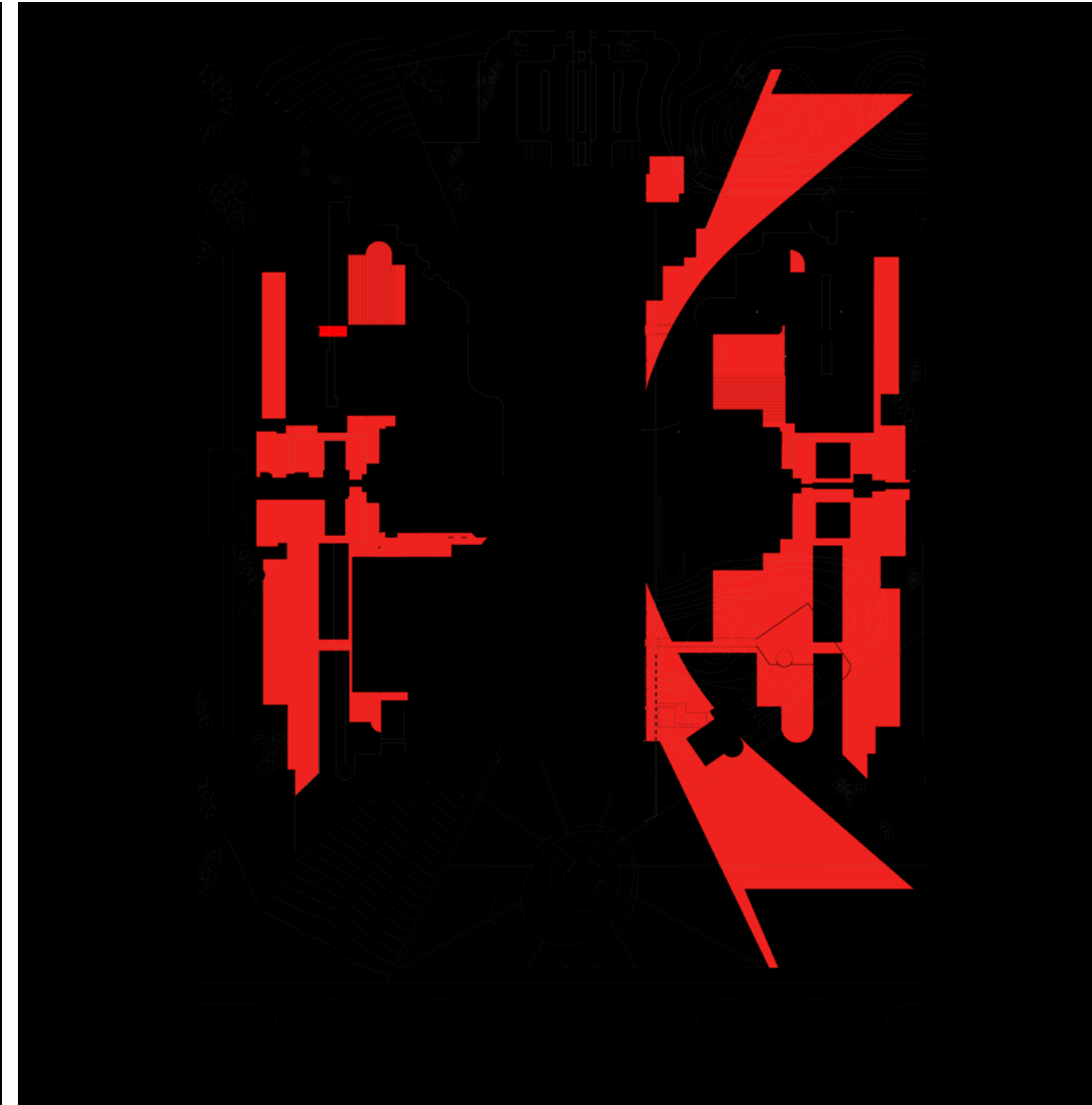

04-b. This image shows the redundancy render, which was sat using layered material on the final poster to indicate what sections of the diagram were going to be 'removed' in the project.

Amina Basam Portfolio

Commissioned by Architect Amina Basam. This portfolio intended to capture the architect's Masters production efforts. It needed to be unintrusive, so as not to detract from the work, while also maintaining interest as a design object.

Project Details:
Digital Portfolio (PDF),
A4, 210mm x 297mm

Typefaces:
Century Schoolbook
Monospace BT,
Sabon LT Pro
(Roman & Bold)

Collaborators

N/A

Associated

This folio subsequently contributed to Amina securing a position at Greenshoot Consulting.

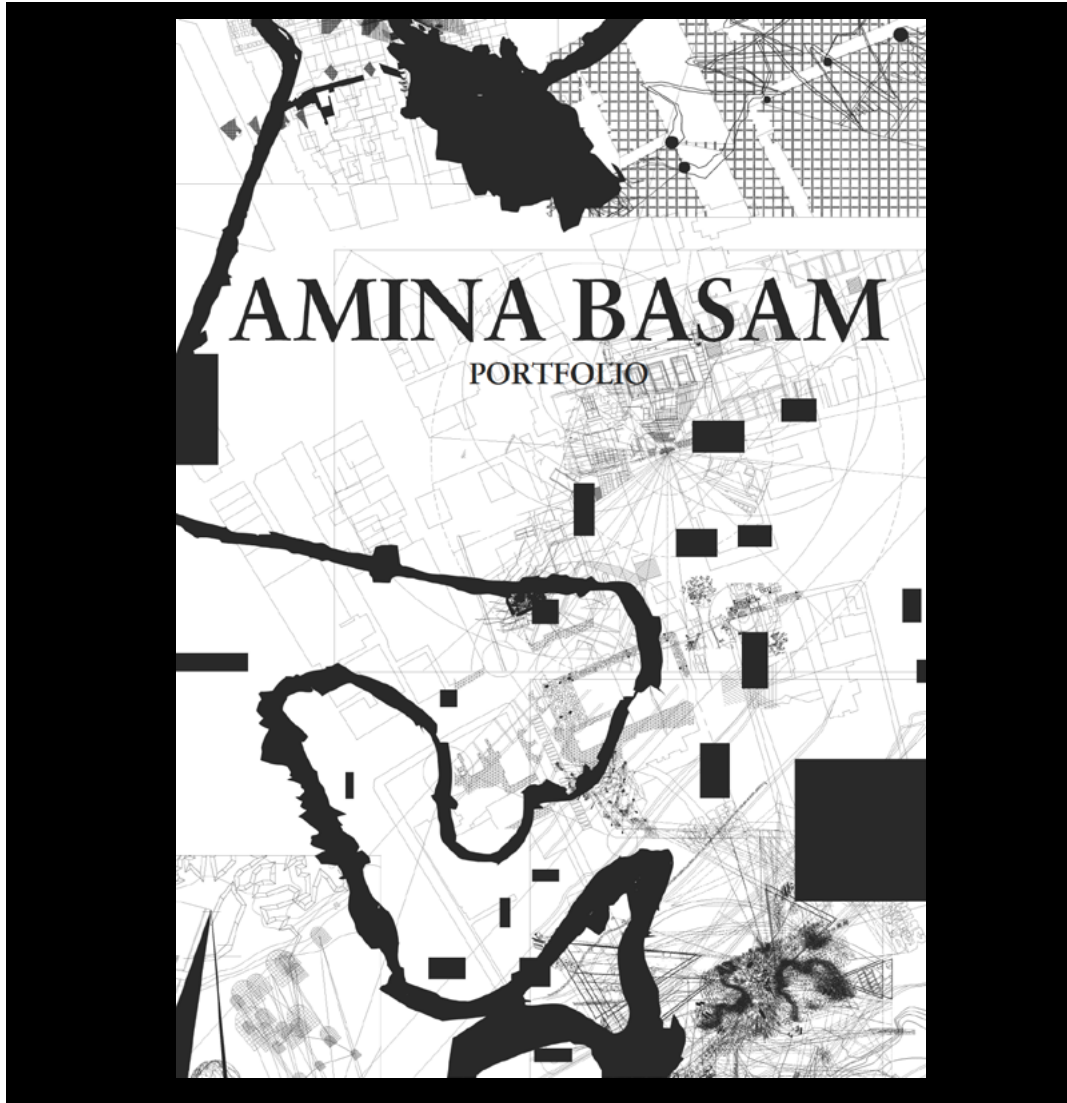

01. Cover page of the document, featuring a graphic work by the architect.

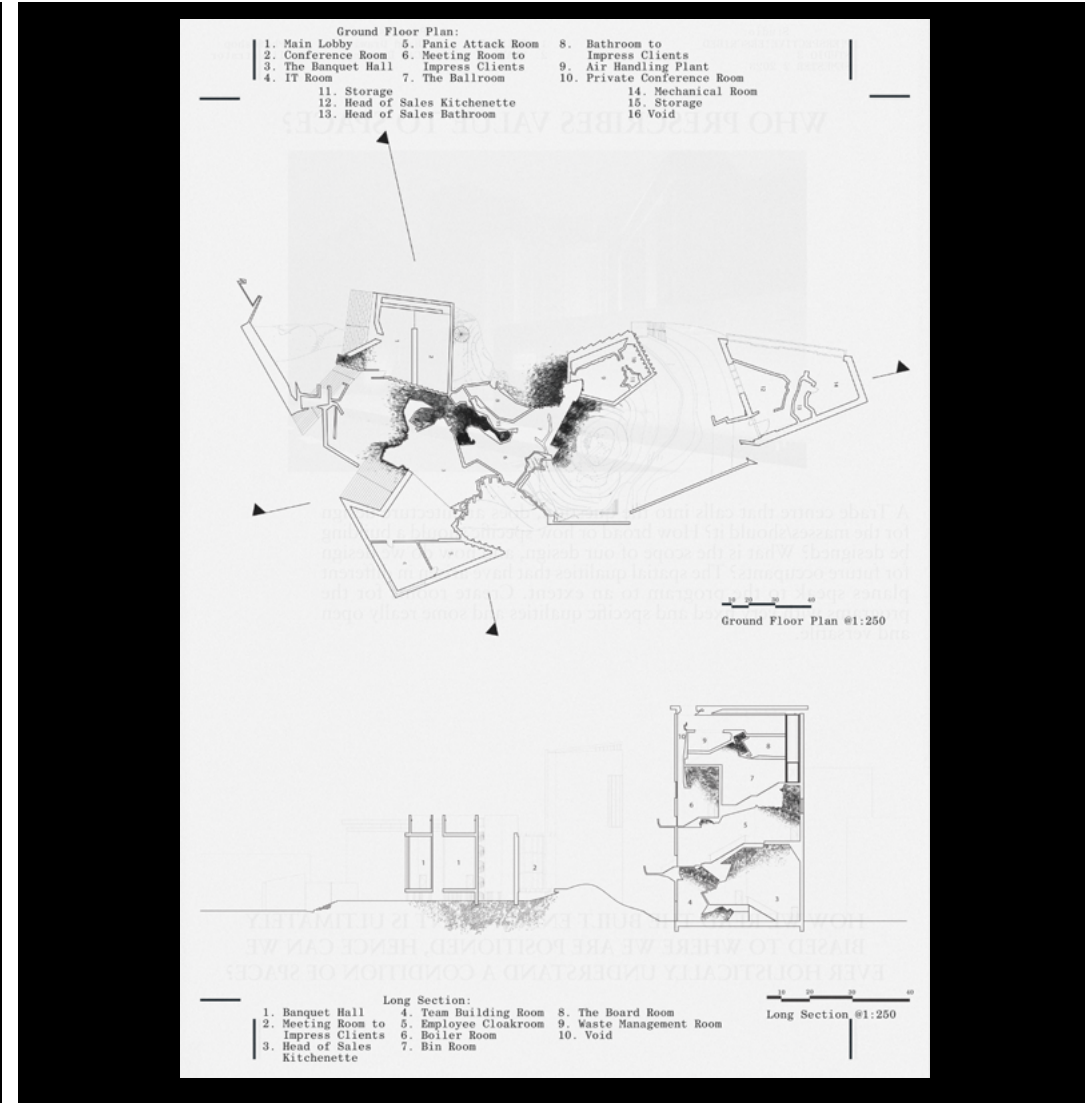

02. An example of the pervasive key system, alongside the registration mark motif. In this spread, the motif is used as a proportionately accurate twist on the a scale key (bottom right).

Amina Basam Portfolio

Commissioned by Architect Amina Basam. This portfolio intended to capture the architect's Masters production efforts. It needed to be unintrusive, so as not to detract from the work, while also maintaining interest as a design object.

Project Details:
Digital Portfolio (PDF),
A4, 210mm x 297mm

Typefaces:
Century Schoolbook
Monospace BT,
Sabon LT Pro
(Roman & Bold)

Collaborators
N/A

Associated
This folio subsequently contributed to Amina securing a position at Greenshoot Consulting.

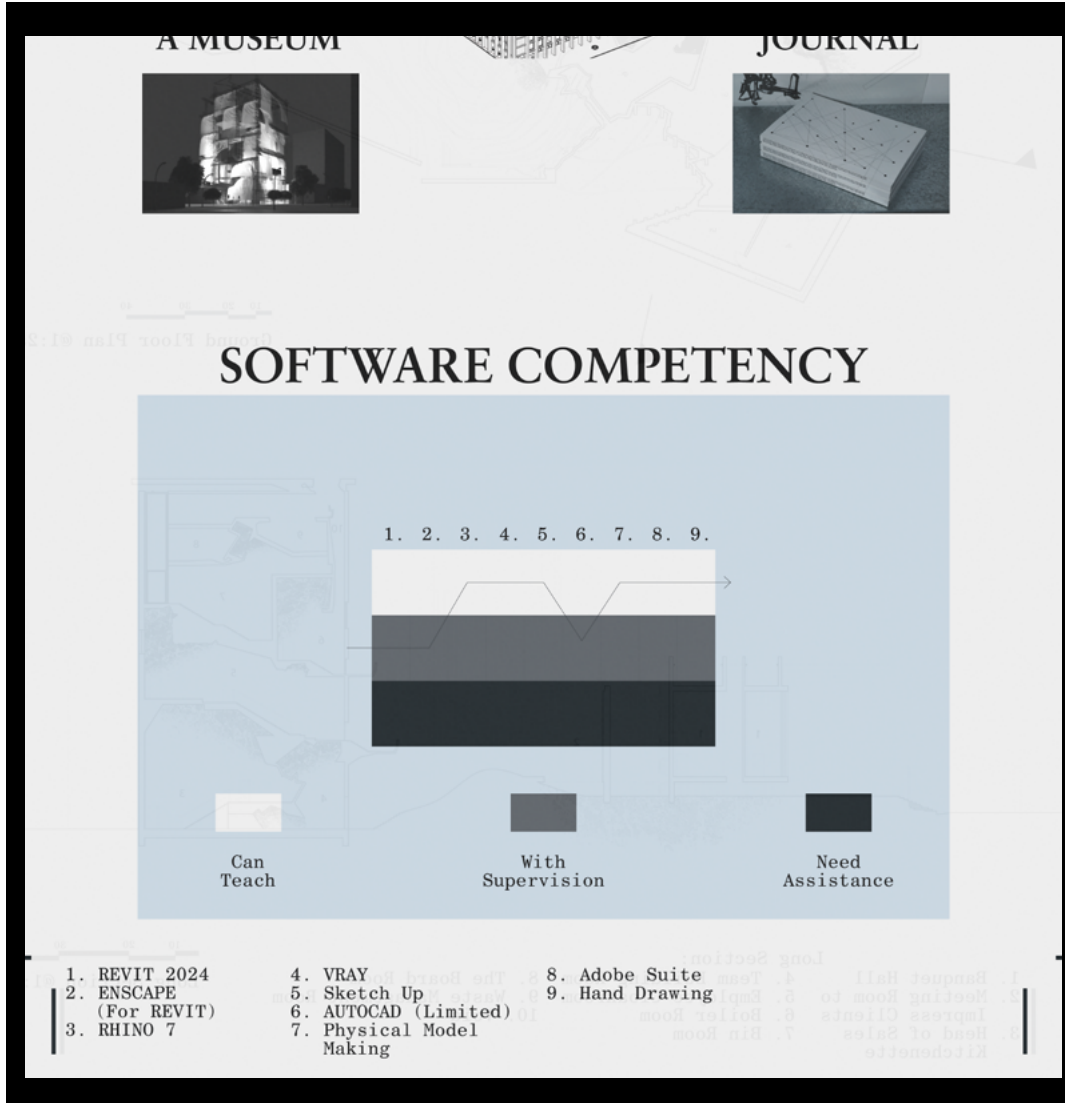

03. An original infographic designed to communicate the architect's software competencies, using a key system to remove clutter from the graphic window.

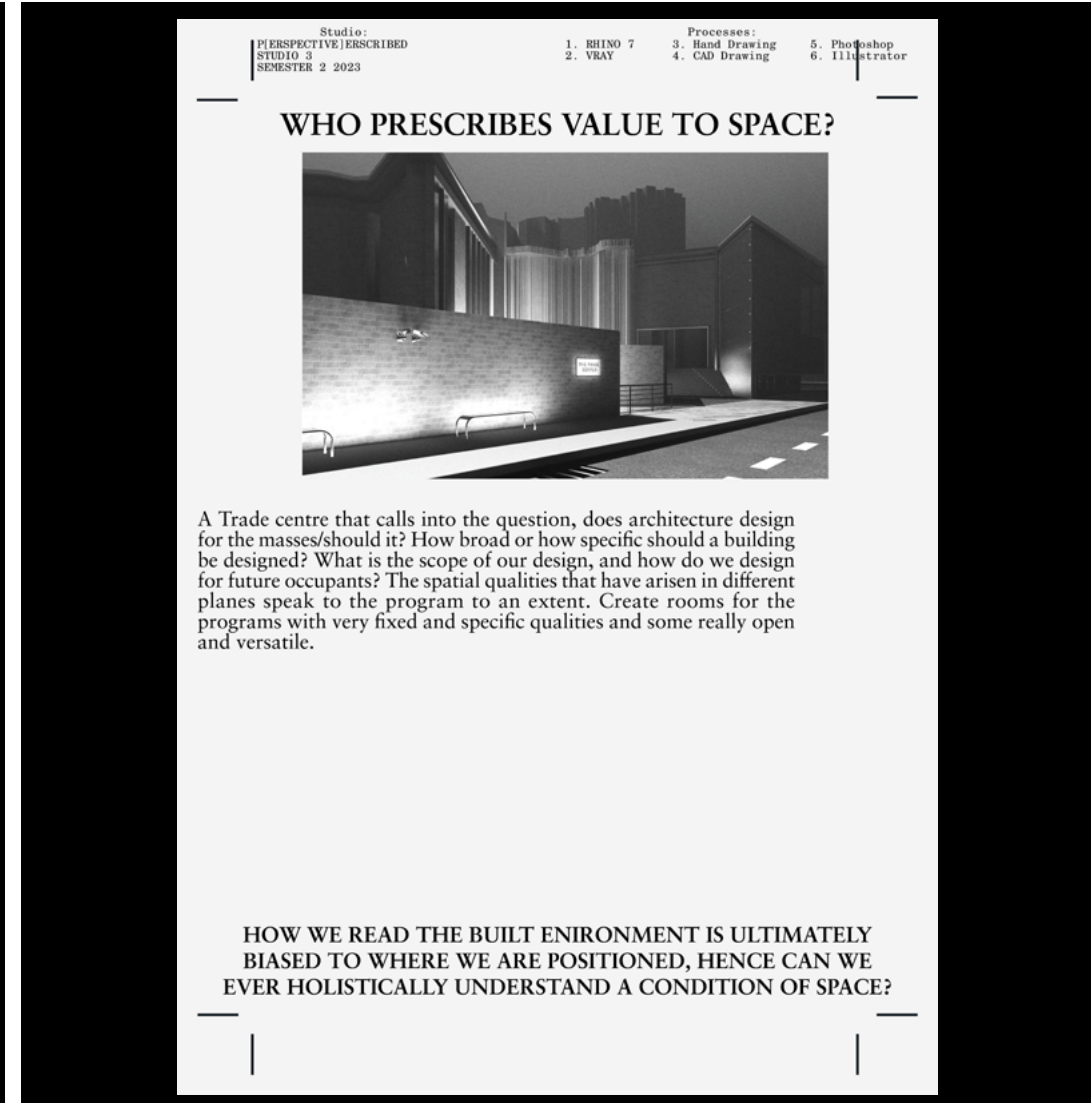

04. A standard page, housing the key, colophon info, a hero image and title treatment alongside body text. This contained a kind of 'pull quote', which was placed at the bottom as an anchor.

PRESS: RMIT UGCD Graduate Showcase

This project was a large scale interconnected exhibition, created over 7 weeks, highlighting graduating talent. The showcase used a pervasive index system that communicated between publication, original website and original print-on-demand system, show environment and photography.

Project Details:

3x Nested Publication/s:
C. A3 - 330mm x 383mm
B. A4 - 210mm x 297mm
A. Half A3 - 74mm x 210mm

Typefaces:

Pantasia, Unica

Collaborators

Zachariah Micallef
Timon Meury *
Finn Stewart
Liam Kenna
Ella Taylor

Associated

Brad Haylock
Counter-Forms
Wei Huang
Ziga Testen
Suzie Zuzela
Jiayu Chen



01. Nested A,B,C publication that functioned as a show guide, as well as archive document for the show. A (Orange) displays the index, where B and C show Text from the designers as well as image displays of their work.



02. Back cover and colophon information.

PRESS: RMIT UGCD Graduate Showcase

This project was a large scale interconnected exhibition, created over 7 weeks, highlighting graduating talent. The showcase used a pervasive index system that communicated between publication, original website and original print-on-demand system, show environment and photography.

Project Details:
Website
(Desktop & Mobile),
Print - On - Demand
PDF generation tool.

Typefaces:
Pantasia, Unica

Collaborators

Zachariah Micallef *
Timon Meury
Finn Stewart
Liam Kenna *
Ella Taylor

Associated

Brad Haylock
Counter-Forms
Wei Huang
Ziga Testen
Suzie Zuzela
Jiayu Chen

The website is accessible at p-r-e-s-s.com

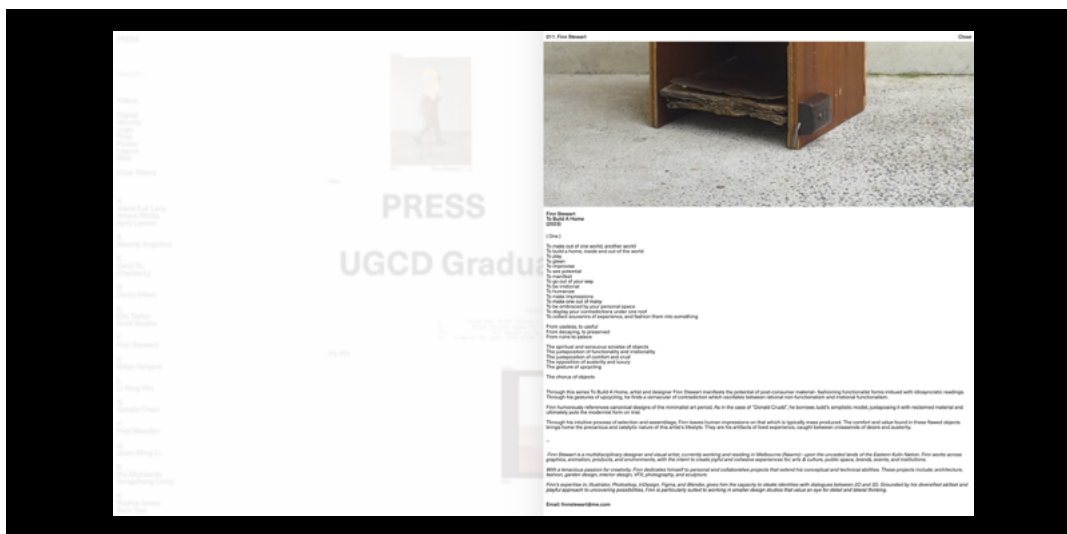

03. 04. View of the website in desktop. Each component is draggable and colour coded by filter type. It follows a progressive disclosure UX methodology, leading users ultimately from the work to the designer's direct contact details.

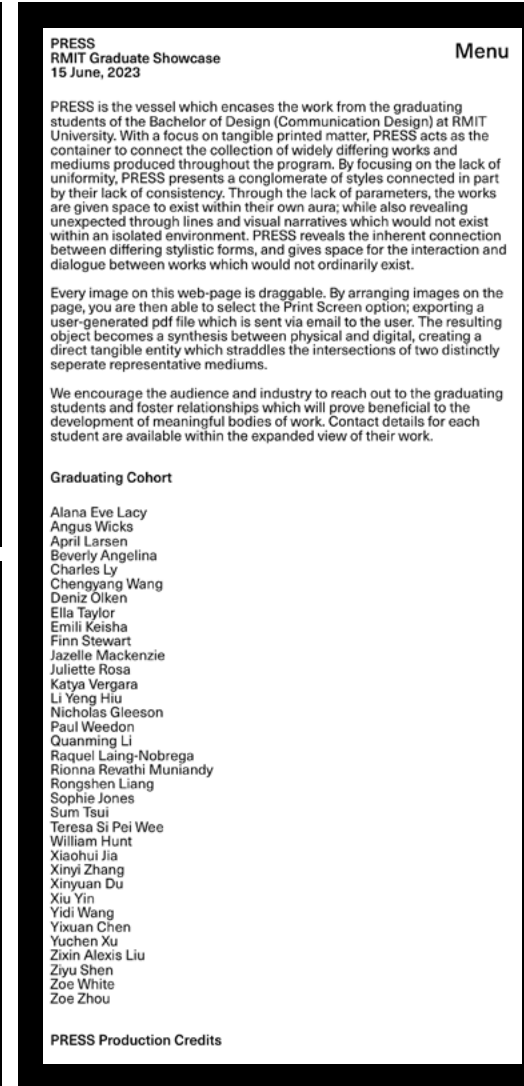

05. 06. Mobile version. Each component of the site's functionality persists on both versions, scaling for device requirements.



PRESS: RMIT UGCD Graduate Showcase

This project was a large scale interconnected exhibition, created over 7 weeks, highlighting graduating talent. The showcase used a pervasive index system that communicated between publication, original website and original print-on-demand system, show environment and photography.

Project Details:
Risographed Duplex Stock,
420mm x 297mm

Typefaces:
Pantasia, Unica

Collaborators

Zachariah Micallef *
Timon Meury *
Finn Stewart
Liam Kenna *
Ella Taylor

Associated

Brad Haylock
Counter-Forms
Wei Huang
Ziga Testen
Suzie Zuzela
Jiayu Chen

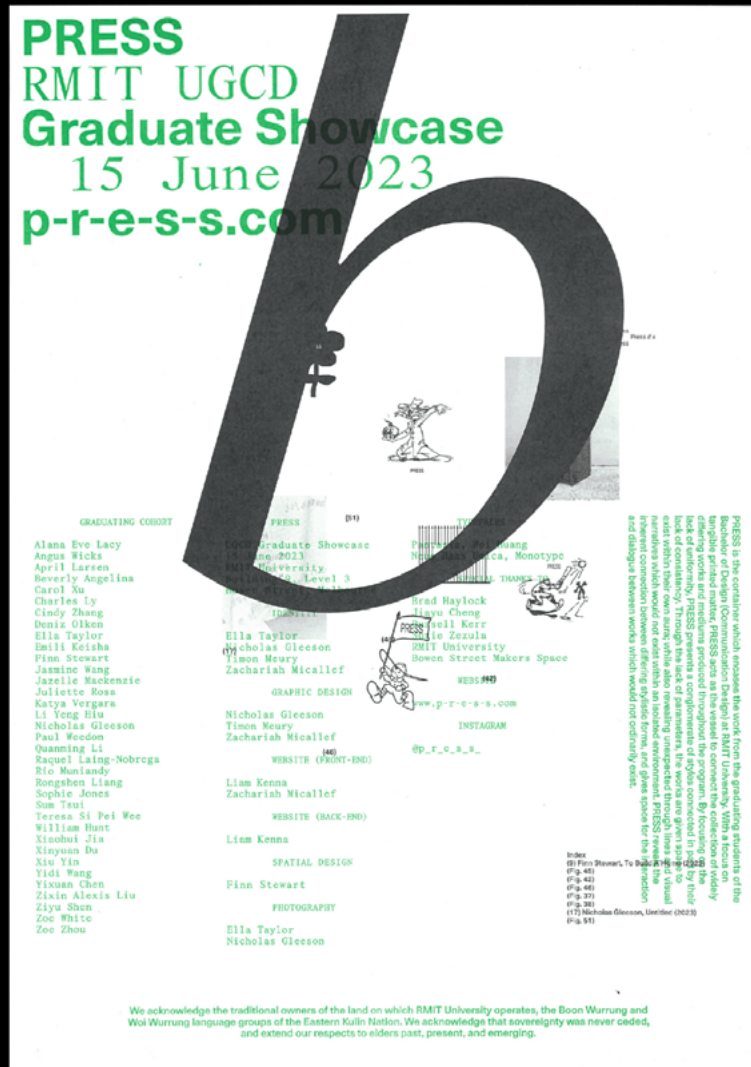

User-Generated Poster Instructions

- 1 Access www.p-r-e-s-s.com via any Mobile or Desktop device.
- 2 Compose the images on the web-page by pressing student names to make images appear, and dragging them to arrange them.
- 3 Press 'Clear Screen' at any time to restart with a blank home screen.
- 4 Once you are happy with the composition, select 'Print Screen' to export a PDF version to the email address you specify.
- 5 Approach the printing area once directed to with your proof of print receipt and the email address you inputted previously.

NOTES

Please follow the instructions from our friendly volunteers.

Please refrain from entering the Makerspace until directed. Production is limited to two posters at a time.

We encourage you to engage with this process outside of this space, using your own device and printer. This can be done on any device - both mobile and desktop - and printed on any inkjet or laser printer that accepts PDFs.

PRODUCTION

The site uses DOMPDF to convert HTML elements to PDF format. Due to the variable nature of device dimensions and aspect ratios, there may be edge cases where some images and components may be placed outside the frame and thus not print correctly.

Although we have tried to make the process as robust as possible, digitally composed arrangements may not translate perfectly to printed form. We do not commit that there will be a 1:1 direct transfer from physical to digital, but we acknowledge that this is an intriguing side-effect of the process employed.

Front-End Development:
Liam Kenna
Zachariah Micallef

Back-End Development:
Liam Kenna

Print Implementation: @sshmiam
Liam Kenna www.liamkenna.com

Print Styling: @3z22j
Zachariah Micallef www.zachmicallef.com

07. The poster generation system that was implemented for the show. It is still accessible online. The type specimen was used as an abstracted architecture, while the composition was user generated. A limited run of riso-posters were produced on the night in a print-workshop run in real time using the process.

PRESS: RMIT UGCD Graduate Showcase

This project was a large scale interconnected exhibition, created over 7 weeks, highlighting graduating talent. The showcase used a pervasive index system that communicated between publication, original website and original print-on-demand system, show environment and photography.

Project Details:
Social Media Campaign,
Photography,
Digital Assets,
Illustration,
Floor Plan,
Vinyl Stickers

Typefaces:
Pantasia, Unica

Collaborators

Zachariah Micallef
Timon Meury
Finn Stewart
Liam Kenna
Ella Taylor

Associated

Brad Haylock
Counter-Forms
Wei Huang
Ziga Testen
Suzie Zuzela
Jiayu Chen



08.

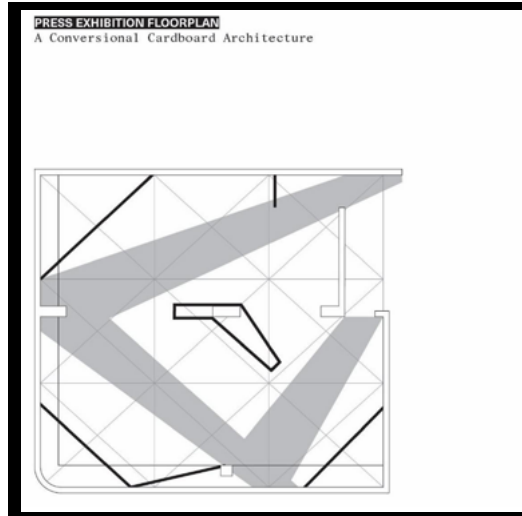

09.

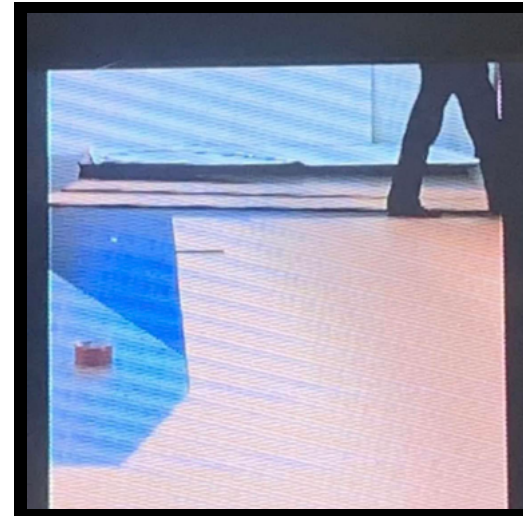

10.



11.

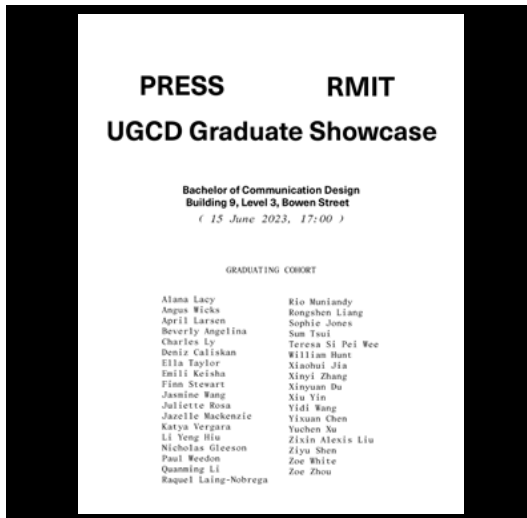

12.



13.

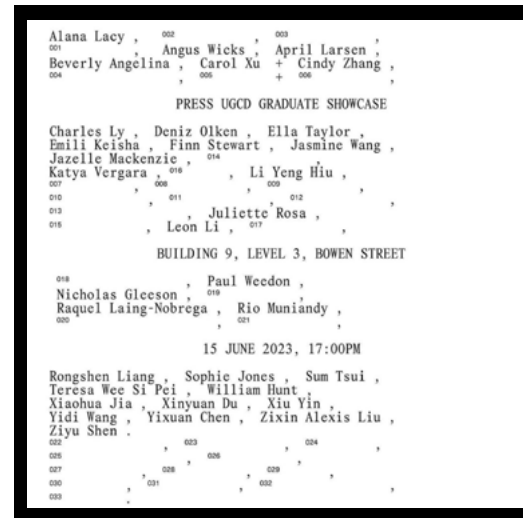

14.

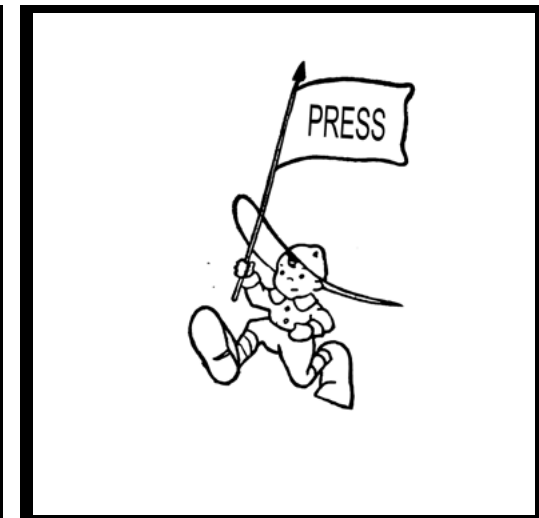

15.

08. 11. Social campaign in collaboration with Counter-Forms & Wei Huang.
09. Floor plans for the exhibition space.
10. Promotional photography

12. Show invite for industry figures.
13. Vinyl stickers pasted on surfaces in the campus environment to lead patrons.
14. 15. Assets designed for the show.

PRESS: RMIT UGCD Graduate Showcase

This project was a large scale interconnected exhibition, created over 7 weeks, highlighting graduating talent. The showcase used a pervasive index system that communicated between publication, original website and original print-on-demand system, show environment and photography.

Project Details:
Documentation by
Anna Kafcaloudis and
Ziga Testen

Typefaces:
Pantasia, Unica

Collaborators
Zachariah Micallef
Timon Meury
Finn Stewart
Liam Kenna
Ella Taylor

Associated
Brad Haylock
Counter-Forms
Wei Huang
Ziga Testen
Suzie Zuzela
Jiayu Chen



16.

16. Vinyl Sticker placed at the show entrance on a reclaimed lightbox.



17.

17. A contributor's project, alongside the floor didactic.



18.

18. The publication presentation for attendees to take their own.



19.

19. A slice of the exhibition environment.

Contact information

e: n@0-ln.co
@: moma1000000, 0_ln_
www: nicholasgleeson.com, 0-ln.co
p: (+04) – 68 – 381 – 320

Thank you.