

Olivia Champ Tremml + Lilly Saniei-Banrey
Nexus of Ecology, Education, and Design

Puddled
Pedagogies:
A New Design
School for
Chongming
Island

The Basic Information

Premise

The new Design School at Yangtse Estuary on Chongming Island brings into balance the life of the designer through tender connection to one's surroundings. Students live close to studios, workshops, and seminars under the greater canopy of departments as live-in artist residency program unique to the typical campus structure. The school purposefully slows down and intermingles making and reflecting, where students return to instinct, feeling, and exploring the

Departments

Industrial Design
Furniture Design
Communication Design
Textile Design
Fashion Design

Workshops

Textile
Metal
Ceramic
Glass
Wood + Organic
Synthetic + Composite
Media Lab

Public Offerings

Herbarium
Large Theater (330 seats)
Light Box Theater
Design Library
Cafe

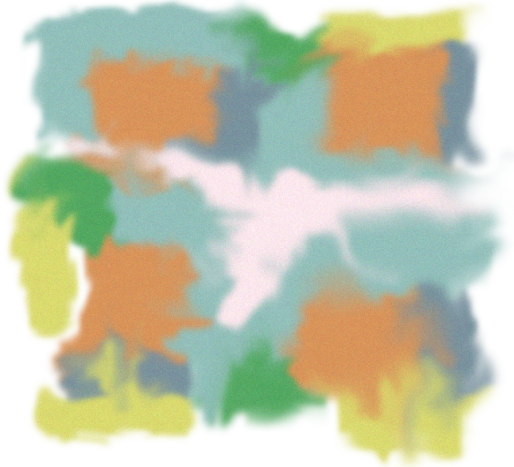

A Building of Rooms

Department Canopies

The School acts as a garden for the campus, an ever evolving and unfolding experience for both student and visitor. Students move through the canopied landscape, providing both depth and breadth to the educational journey.

Key

- | | |
|------------------------|---------------------|
| 1 Textile Design | 4 Furniture Design |
| 2 Fashion Design | 5 Industrial Design |
| 3 Communication Design | |

From Theater to Home

Within Department Canopies, students travel between work and home through restorative landscapes. At the ground floor, porous workshops and public programs land the theater of making. On the above floors, dwelling, sleeping, making and exhibit mingle in a skyward landscape.

Key

- | | | |
|------------|-----------------|---------------|
| A Studio | D Seminar | G Public |
| B Admin | E Living | H Mechanical/ |
| C Workshop | F Sleeping Unit | Receiving |

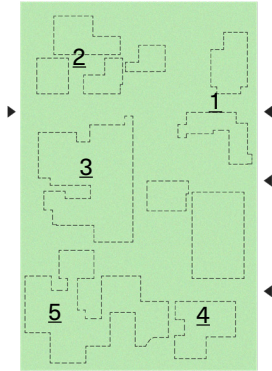

L00

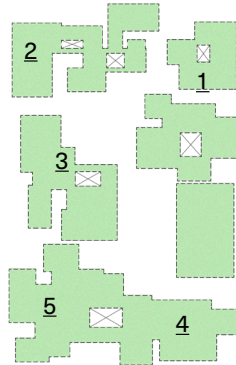

L01

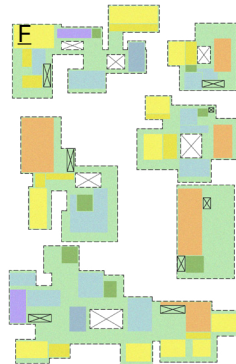
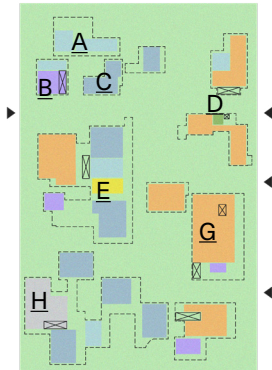

Inter-Department
Paths
Trunks + Branches

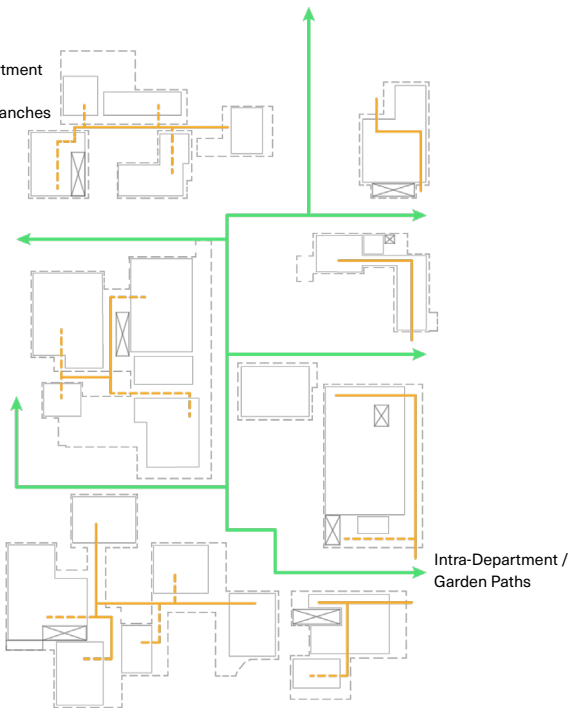

L0 Paths of Circulation

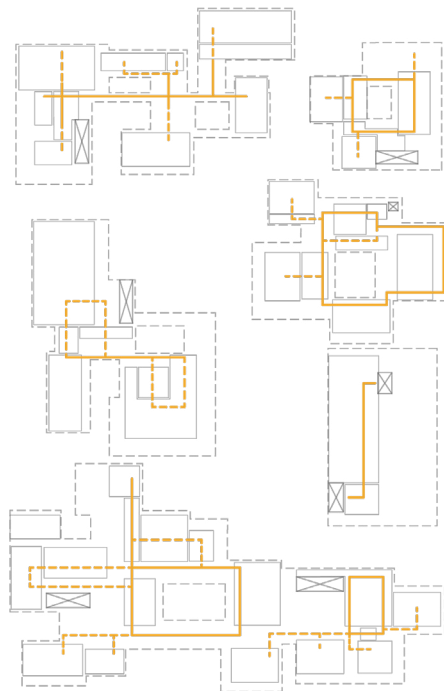

L1 Paths of Circulation









Puddled Pedagogies







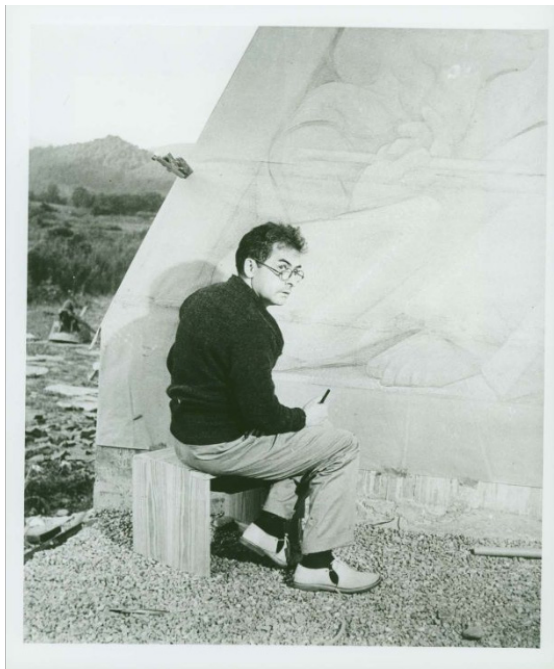

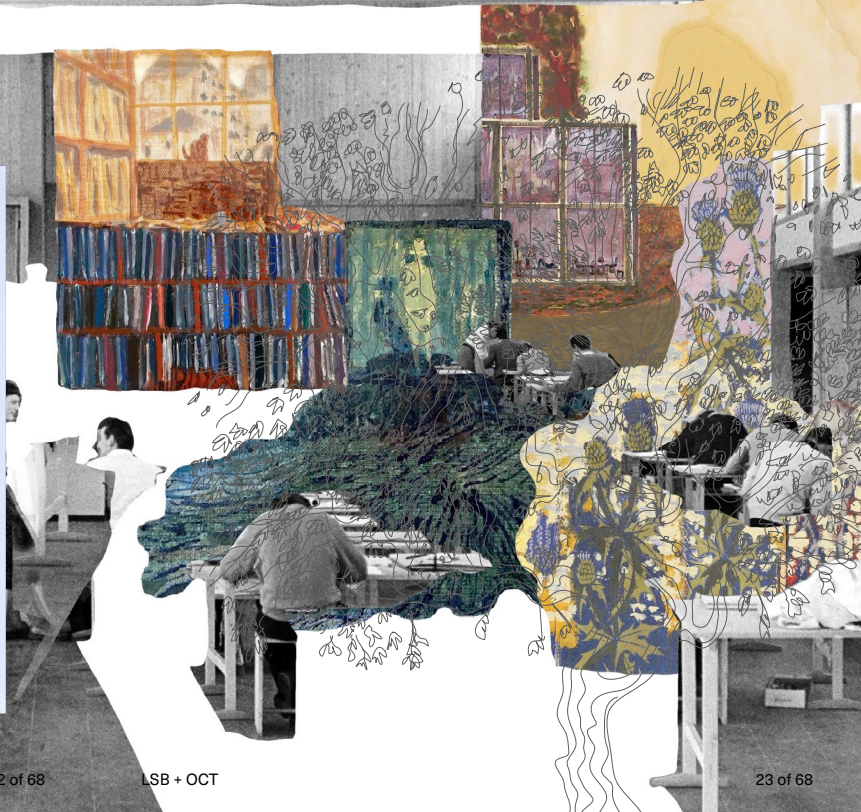

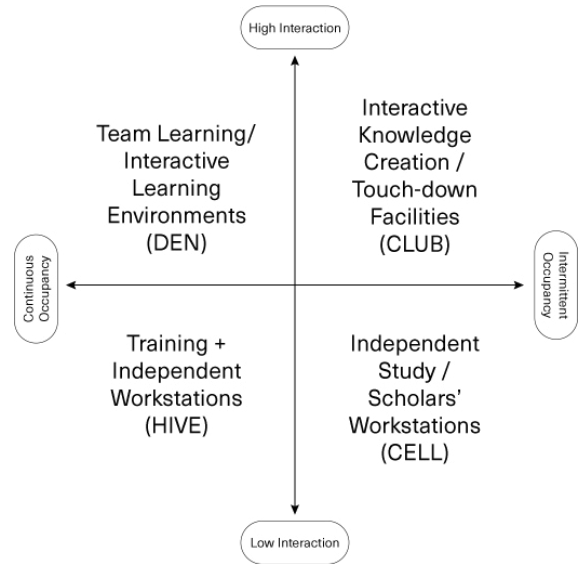

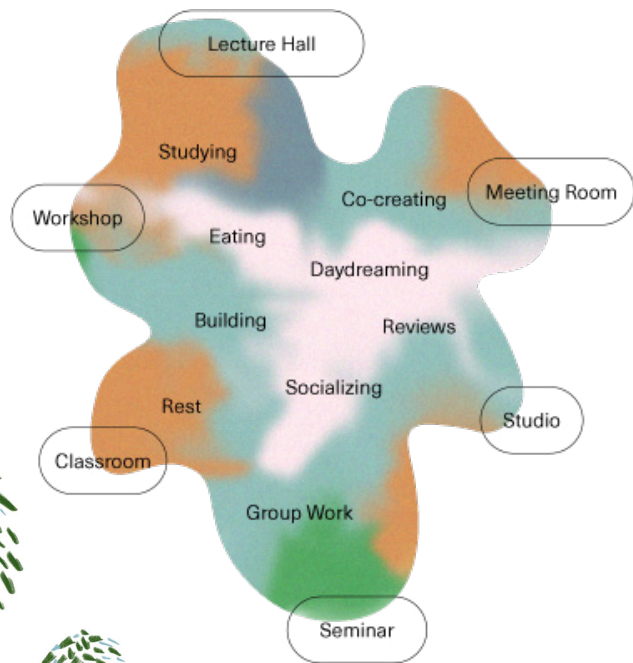



X



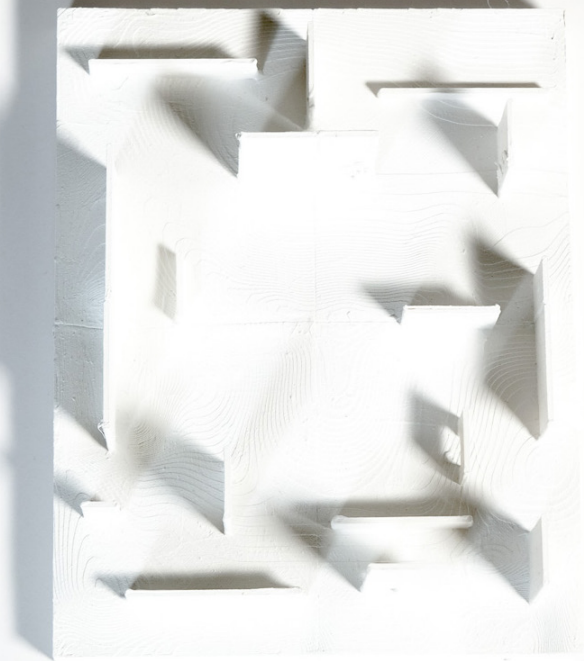

FLORIDA AGRICULTURAL WETLANDS

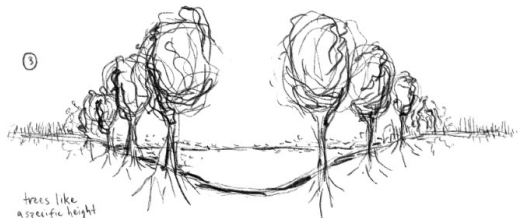

trees like a specific height of water - too deep and they won't grow, creating a ring around the pond that fans out.

"cypress donut"



Ponds take many shapes - not always perfectly gradual

"watering hole"



The "mother tree" grows first at the center. Her seedlings spread out from there - youngest & furthest away, oldest & closest in the most water.

"cypress dome"



shade is dominant on north side, even on google earth

cattle dot the fields

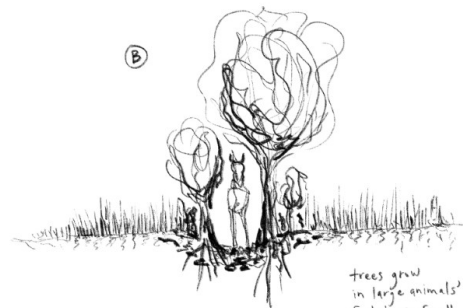

natural, shaded "wetland path" through a field

trees grow in large animals' footsteps. Small animals flock to shade, water, + micro-climate - a place to hide, feel safe, and travel



Birds watch fields from above and hunt

distant tree dome

ONE wet spot (puddle) + ONE accidental seed → grows into a lone tree in the middle of a field (palm tree only needs small water)

livestock + wild animals together travel to water + shade of "Cypress Dome," their feet + walking create a "wet path" along the way for new trees to grow

animals walking cypress grows water + collects rain water in their tracks



DIAOJAO "HANGING FEET BUILDING"

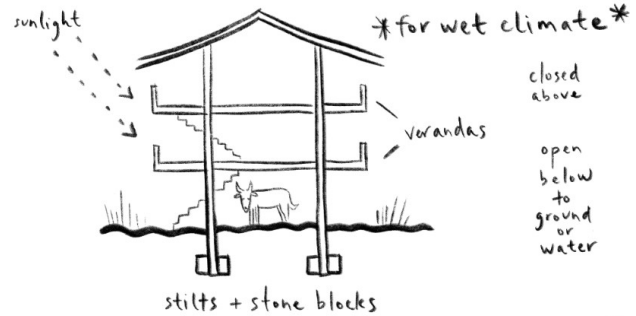

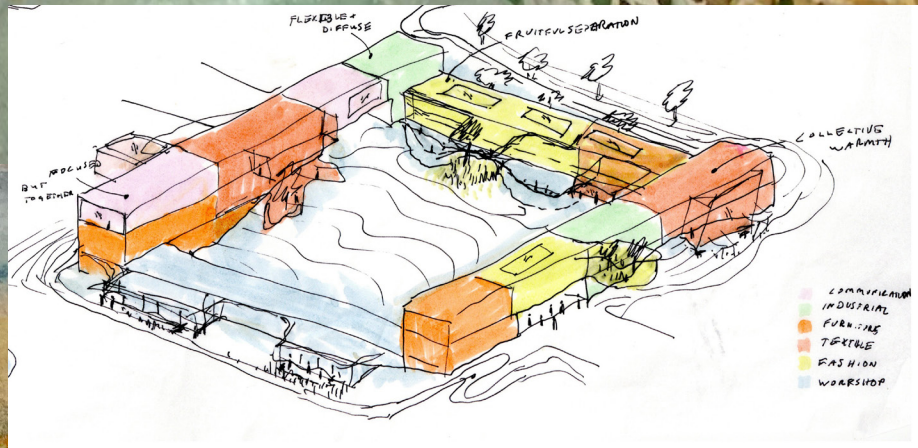
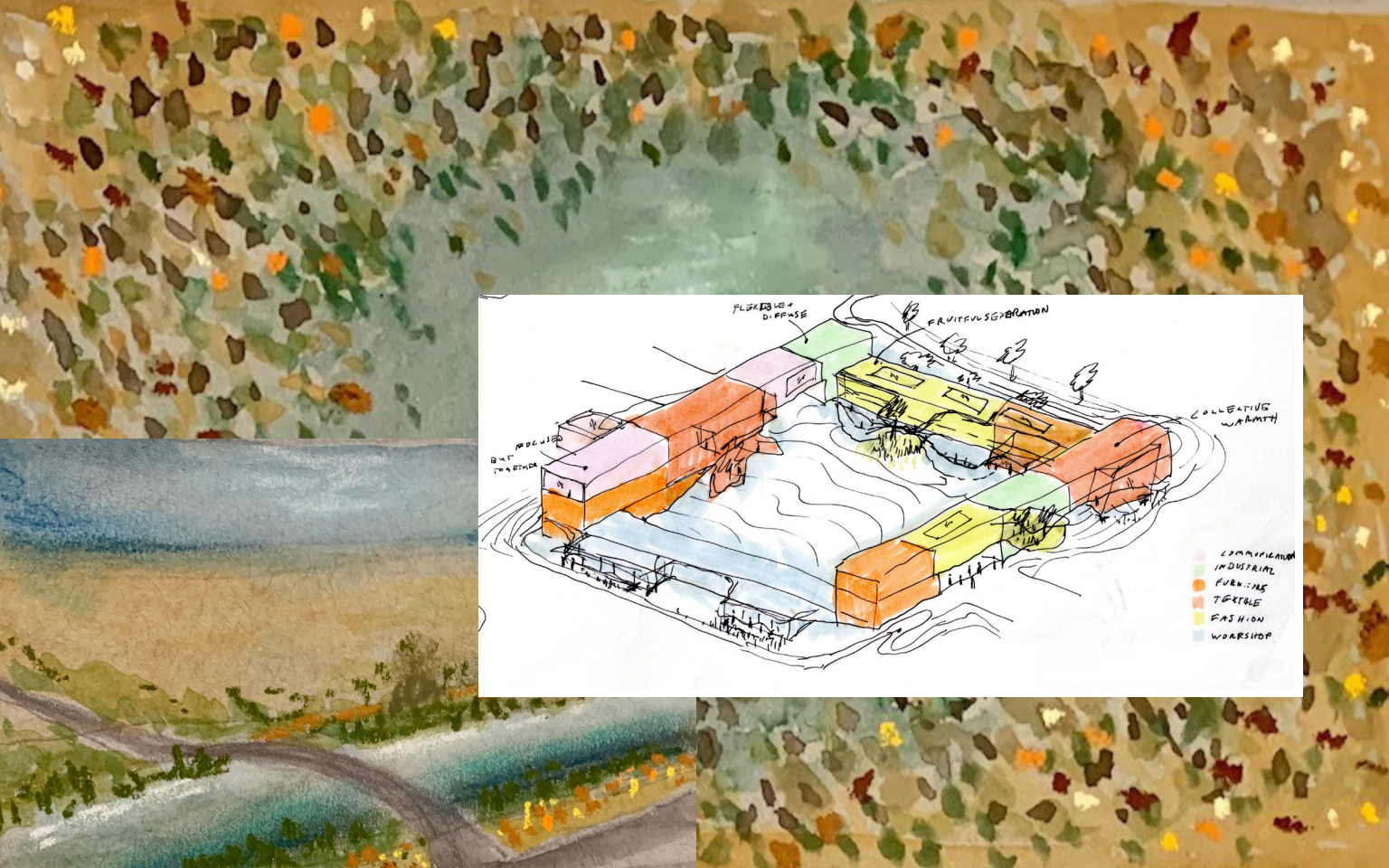

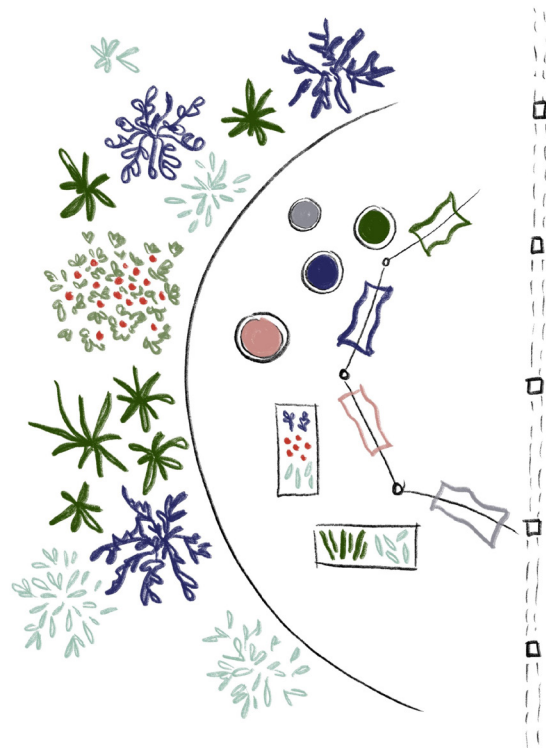

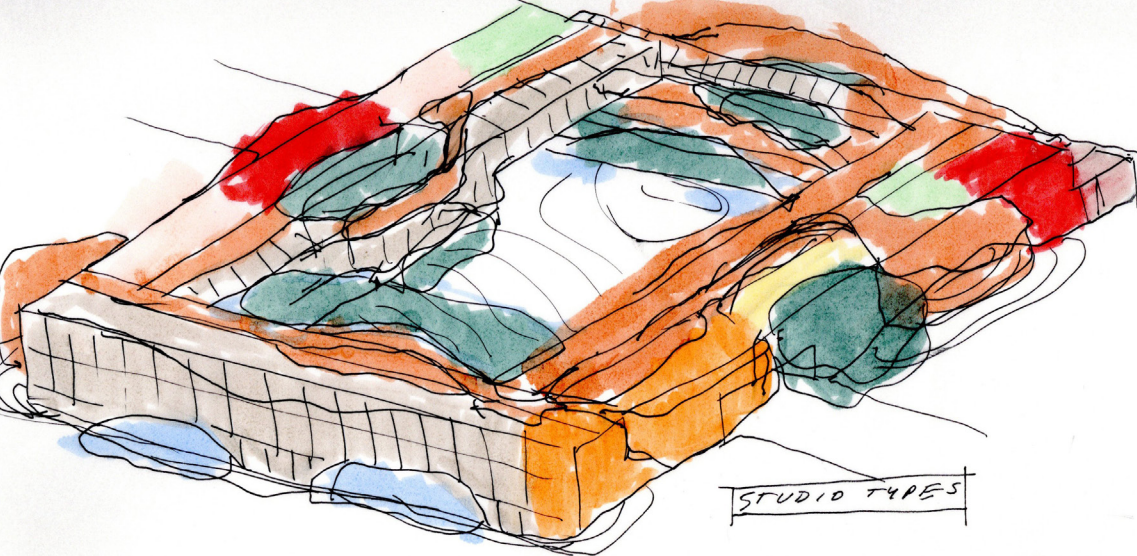

STUDIO TYPES



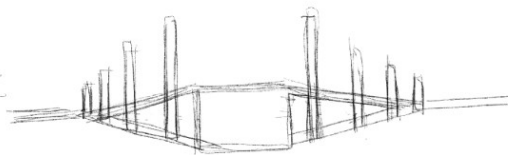
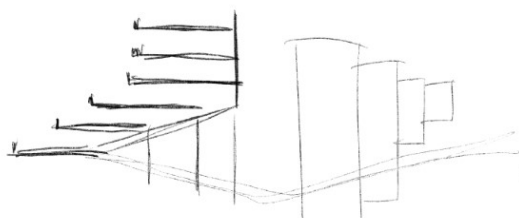

Space of Venture



Space of Linging



Space of Storage



Space of Care



Public-Public



Spaces of Collectivism

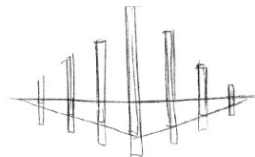

Private-Public





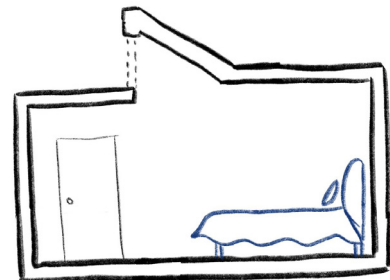

EXCITINGLY QUIET SPACES

THINK+MAKE, THINK+REST
REST ALLOWS MIND TO SIFT IDEAS,
TO FILL+EMPTY+RESET.
LEARN TO QUIET+SPARK YOUR MIND

DISTANCE

ARCHITECTURE TO BALANCE
QUIETLY EXCITING +
EXCITINGLY QUIET SPACES

WETLANDS ARE TRANSITIONAL ZONES

COLLEGE IS TRANSITIONAL TIME





Fresco Barn, outside to inside

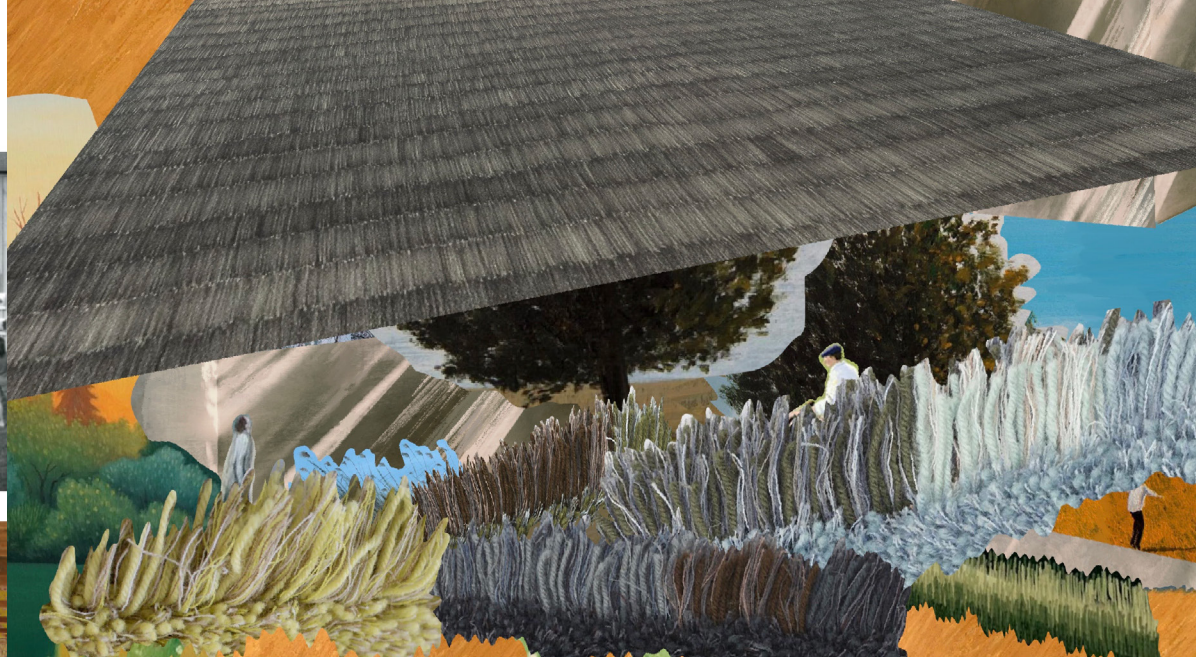

WHAT ABOUT PROFESSORS?

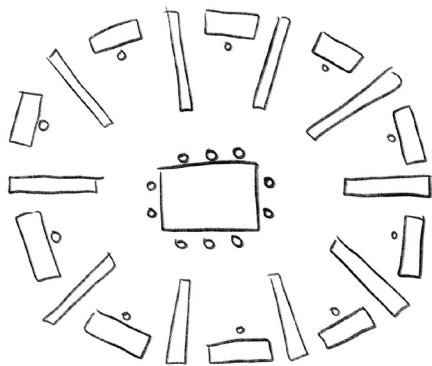

PROFESSOR STUDIO

IF "TEACHERS ARE STUDENTS
AND STUDENTS ARE TEACHERS,"
THEN PROFESSORS NEED STUDIOS,
COLLABORATION SPACES TOO



PROFESSORS' REFLECTING POND -
HUMBLING

PROFESSORS NEED TO LEARN
FROM EACH OTHER + EXCHANGE
IDEAS TOO - THEY NEED TO
KEEP MAKING TOO!
LEAD BY EXAMPLE

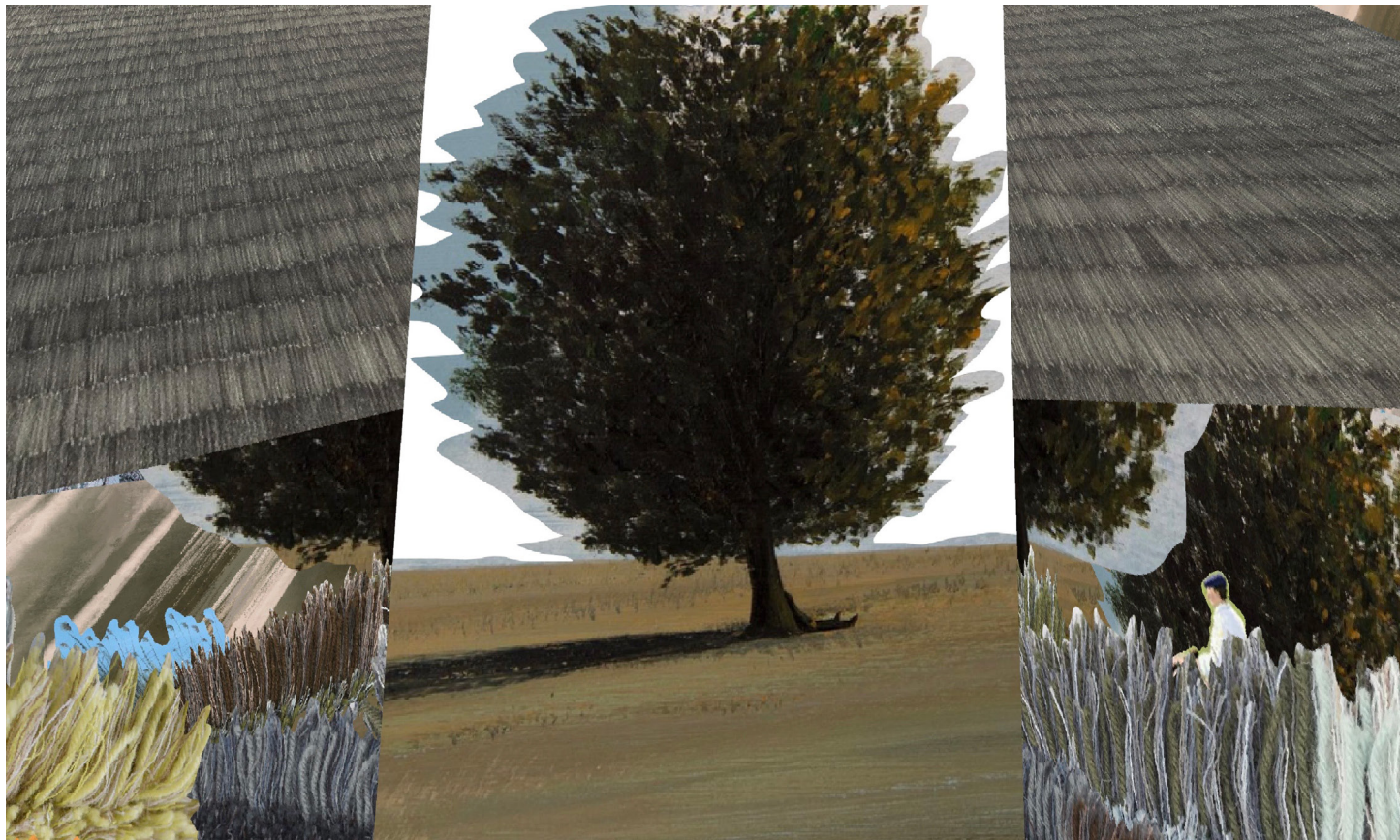



THE INTERWOVEN, COMPLEX EDGES OF WETLANDS



upper levels - grow towards
sun + photosynthesis =
PRODUCTION
plants doing WORK

"ground level" allows animals
to navigate, hide,
eat, live, + find
light + air (oxygen)

below
water/ground
is a carpet/tapestry
of roots - structure +
stability + absorption

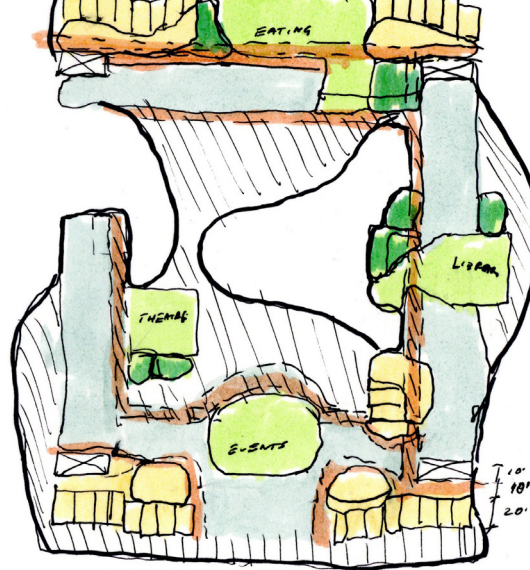

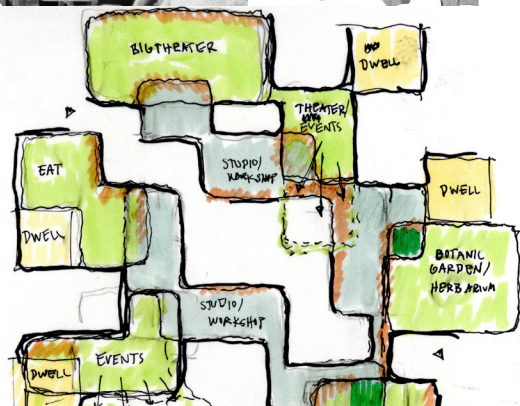
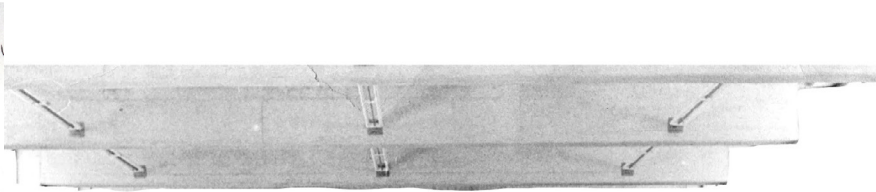

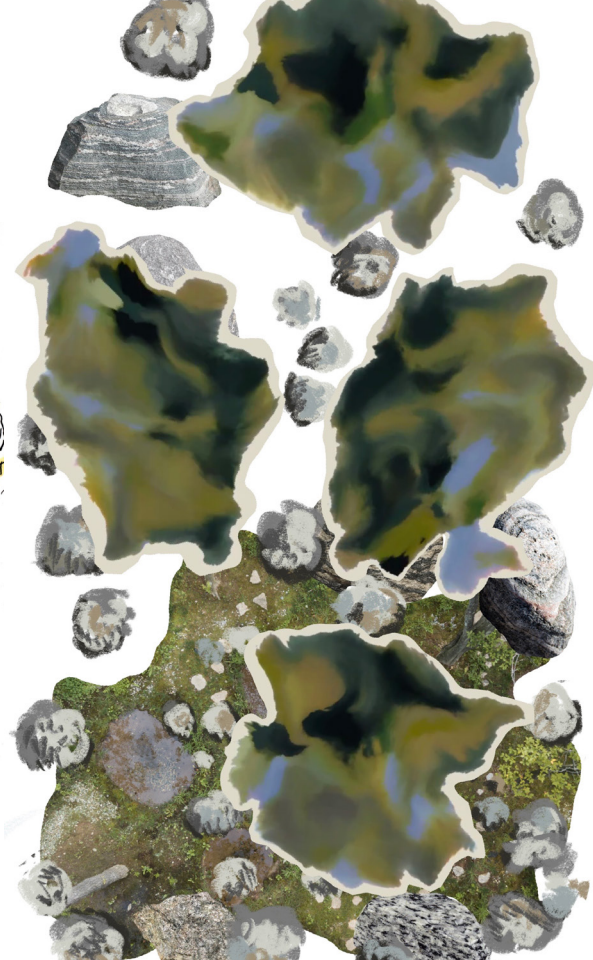
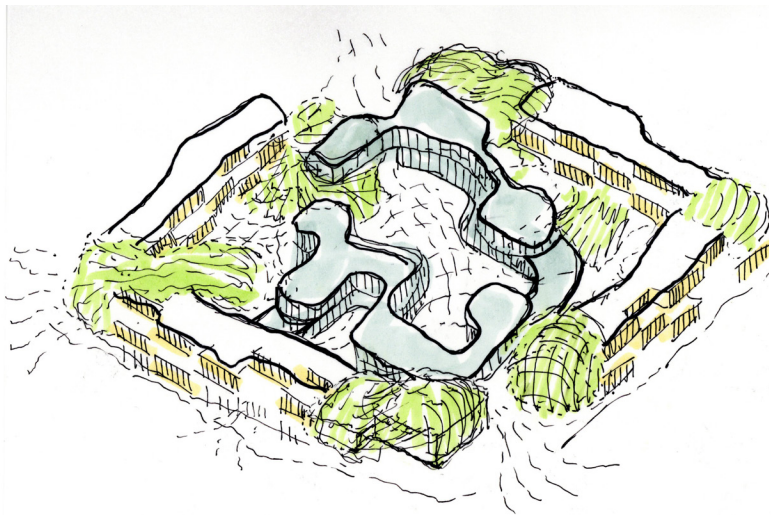



WHAT IS A LIBRARY?



HERBARIUM - LIBRARY OF
NATURE'S DESIGN

A COLLECTION OF KNOWLEDGE,
MEMORY, + HISTORY IN MANY FORMS



A PLACE TO FERMENT,
STEEP (LIKE TEA)
IN INSPIRATION



AN OBJECT DISPLAY
IS A COLLECTION
OF MATERIALIZED
IDEAS

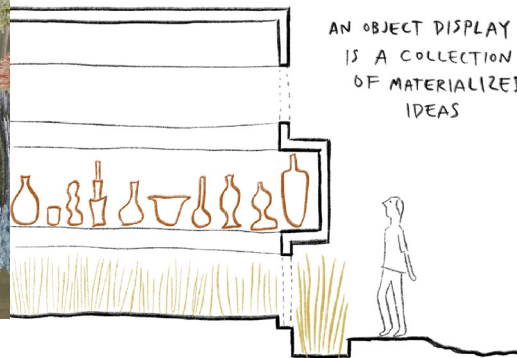

READ BETWEEN
THE LINES

